

## 平行夹 Parallel Gripper

## 加长平行夹 Lengthen Parallel Gripper

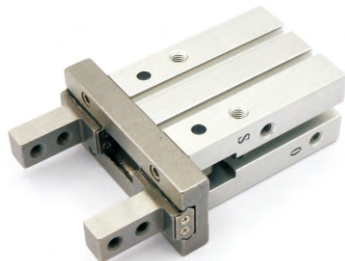

型号(Model)	S	GMHZ2-10S	GMHZ2-16S	GMHZ2-20S	GMHZ2-25S	GMHZ2-32S	GMHZ2-40S
	D	GMHZ2-10D	GMHZ2-16D	GMHZ2-20D	GMHZ2-25D	GMHZ2-32D	GMHZ2-40D
缸径 Bore		10	16	20	25	32	40
使用流体 Fluid		空气 Air					
使用压力 范围(MPa)	单作用 Single action	0.35~0.7	0.25~0.7				
Operating pressure range	双作用 Double action	0.2~0.7	0.1~0.7				
环境及流体温度 Environment and fluid temperature		-10~60℃					
重复精度(mm) Repeatability accuracy		±0.01				±0.02	
最高使用频率(c.p.m) Maximum frequency of use		180				60	
动作方式 Action mode		单作用·双作用 Single action · Double action					
磁性开关(可选项) Magnetic switch (optional)		无触点磁性开关 Contactless magnetic switch					
接管口径 Pipe Size		M3×0.5	M5×0.8				
重量(Weight)	S	53g	123g	227g	309g	415g	543g
	D	52.5g	120g	225g	314g	410g	537g

型号(Model)	S	GMHZL2-10S	GMHZL2-16S	GMHZL2-20S	GMHZL2-25S
	D	GMHZL2-10D	GMHZL2-16D	GMHZL2-20D	GMHZL2-25D
缸径 Bore		10	16	20	25
使用流体 Fluid		空气 Air			
使用压力 范围(MPa)	单作用 Single action	0.35~0.7	0.25~0.7		
Operating pressure range	双作用 Double action	0.2~0.7	0.1~0.7		
环境及流体温度 Environment and fluid temperature	-10~60℃				
重复精度(mm) Repeatability accuracy	±0.01				
最高使用频率(c.p.m) Maximum frequency of use	120				
动作方式 Action mode	单作用·双作用 Single action · Double action				
磁性开关(可选项) Magnetic switch (optional)	无触点磁性开关 Contactless magnetic switch				
接管口径 Pipe Size		M3×0.5	M5×0.8		
重量(Weight)	S	63g	139g	218g	302g
	D	59g	130g	211g	293g

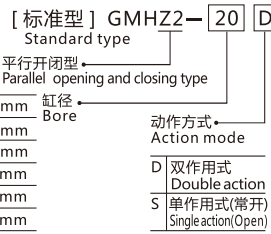
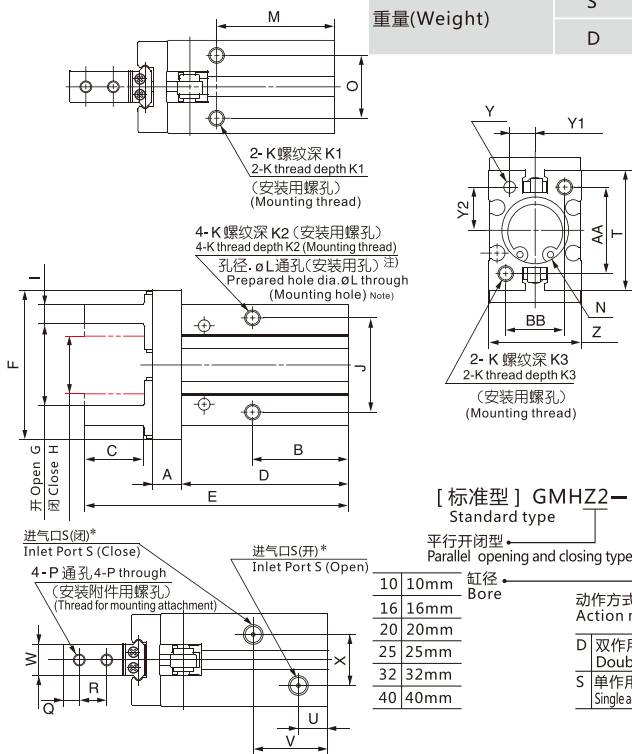

夹持力 / Gripping force

型号 Model	夹持力 N/ Gripping force N			开闭行程 (两侧) mm
	每个手指夹持力的有效值 Gripping force per finger Effective value			
	双动(D) Double action		单动(S) Single action	Opening/Closing stroke (Both sides) (mm)
	外径/External	内径/Internal	外径/External	
	GMHZ2-10 □	11	17	
GMHZ2-16 □	34	45	27	6
GMHZ2-20 □	42	66	33	10
GMHZ2-25 □	65	104	45	14
GMHZ2-32 □	158	193	131	22
GMHZ2-40 □	254	318	217	30

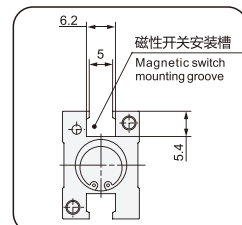
GMHZ2-10□的磁性开关安装槽尺寸  
GMHZ2-10□ Magnetic Switch Mounting  
Groove Dimensions

注) 使用磁性开关时, 气爪不可以通孔安装  
Note) When using Magnetic switches, throughhole mounting is not possible.

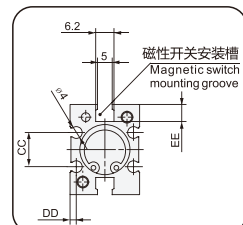
GMHZ2-□□的磁性开关安装槽尺寸  
GMHZ2-□□ Magnetic Switch Mounting  
Groove Dimensions

注) 使用磁性开关 D-Y59、D-Y69 及 D-Y7 时, 气爪不可以通孔安装  
Note) When using Magnetic switches D-Y59、D-Y69、D-Y7, throughhole mounting is not possible.

尺寸表(mm) Dimensions table

缸径(Bore)	A	B	C	D	E	F	G	H	I	J	K	K1	K2	K3	øL	M	N
10	6	23	12	37.8	57	29	15.2 <sup>±0.2</sup>	11.2 <sup>±0.1</sup>	4 <sup>±0.1</sup>	16	M3x0.5	6	5.5	6	2.6	27	ø11H9 $\nabla$ 2
16	7.5	24.5	15	42.5	67.3	38	20.9 <sup>±0.2</sup>	14.9 <sup>±0.1</sup>	5 <sup>±0.1</sup>	24	M4x0.7	4.5	8	8	3.4	30	ø17H9 $\nabla$ 2
20	9.5	29	20	52.8	84.8	50	26.3 <sup>±0.2</sup>	16.3 <sup>±0.1</sup>	8 <sup>±0.1</sup>	30	M5x0.8	8	10	10	4.3	35	ø21H9 $\nabla$ 3
25	11	30	25	63.6	102.7	63	33.3 <sup>±0.2</sup>	19.3 <sup>±0.1</sup>	10 <sup>±0.1</sup>	36	M6x1	10	12	12	5.1	36.5	ø26H9 $\nabla$ 3.5
32	12	40(49)	29	67(76)	113(122)	97	48 <sup>±0.5</sup>	26 <sup>±0.5</sup>	12 <sup>±0.1</sup>	46	M6x1	10	13	13	5.1	48(57)	ø34H9 $\nabla$ 4
40	15	49(62)	36	83(96)	139(152)	119	60 <sup>±0.7</sup>	30 <sup>±0.5</sup>	14 <sup>±0.1</sup>	56	M8x1.25	13	16	17	6.6	58(71)	ø42H9 $\nabla$ 4

缸径(Bore)	O	P	Q	R	S	T	U	V	W	X	Y	Z	Y1	Y2	AA	BB	CC	DD	EE
10	11.4	M2.5×0.45	3	5.7	M3×0.5	23	9	19	5 <sup>±0.05</sup>	11	ø2H9 $\nabla$ 3	16.4 <sup>±0.05</sup>	5.2 <sup>±0.02</sup>	7.6 <sup>±0.02</sup>	18	12	-	-	-
16	16	M3×0.5	4	7	M5×0.8	30.6	7.5	19	8 <sup>±0.05</sup>	13	ø3H9 $\nabla$ 3	23.6 <sup>±0.05</sup>	6.5 <sup>±0.02</sup>	11 <sup>±0.02</sup>	22	15	11.6	2.1	5.8
20	18.6	M4×0.7	5	9	M5×0.8	42	10	23	10 <sup>±0.05</sup>	15	ø4H9 $\nabla$ 4	27.6 <sup>±0.05</sup>	7.5 <sup>±0.02</sup>	16.8 <sup>±0.02</sup>	32	18	14	2.1	9
25	22	M5×0.8	6	12	M5×0.8	52	10.7	23.5	12 <sup>±0.05</sup>	20	ø4H9 $\nabla$ 4	33.6 <sup>±0.05</sup>	10 <sup>±0.02</sup>	21.8 <sup>±0.02</sup>	40	22	19	3.5	11.5
32	26	M6×1	7	14	M5×0.8	60	11	31(37)	15 <sup>±0.05</sup>	24	ø5H9 $\nabla$ 5	40 <sup>±0.1</sup>	12 <sup>±0.02</sup>	23 <sup>±0.02</sup>	46	26	24	3.3	11.5
40	32	M8×1.25	9	17	M5×0.8	72	12	38(45)	18 <sup>±0.05</sup>	28	ø5H9 $\nabla$ 5	48 <sup>±0.1</sup>	14 <sup>±0.02</sup>	29 <sup>±0.02</sup>	56	32	29.4	3.7	13

注) ( ) 内的尺寸为单动的尺寸

尺寸表(mm) Dimensions table

缸径(Bore)	A	B	C	D	E	F	G	H	I	J	K	K1	K2	K3	øL	M	N
10	6	25(35)	12	37.8(47.8)	57(67)	35	19.2 <sup>±0.2</sup>	11.2 <sup>±0.1</sup>	4 <sup>±0.1</sup>	16	M3x0.5	6	5.5	6	2.6	29(39)	ø11H9 $\nabla$ 2
16	7.5	31(36)	15	45.2(50.2)	70(75)	47	26.9 <sup>±0.2</sup>	14.9 <sup>±0.1</sup>	5 <sup>±0.1</sup>	24	M4x0.7	4.5	8	8	3.4	36(41)	ø17H9 $\nabla$ 2
20	9.5	36(42)	20	58(64)	90(96)	62	34.3 <sup>±0.2</sup>	16.3 <sup>±0.1</sup>	8 <sup>±0.1</sup>	30	M5x0.5	8	10	10	4.3	43(49)	ø21H9 $\nabla$ 3
25	11	40(50)	25	66.9(76.9)	106(116)	75	41.3 <sup>±0.2</sup>	19.3 <sup>±0.1</sup>	10 <sup>±0.1</sup>	36	M6x1	10	12	12	5.1	48(58)	ø26H9 $\nabla$ 3.5

缸径(Bore)	O	P	Q	R	S	T	U	V	W	X	Y	Z	Y1	Y2	AA	BB	CC	DD	EE
10	11.4	M2.5×0.45	3	5.7	M3×0.5	23	8	21(31)	5 <sup>±0.05</sup>	11	ø2H9 $\nabla$ 3	16.4 <sup>±0.05</sup>	5.2 <sup>±0.02</sup>	7.6 <sup>±0.02</sup>	18	12	-	-	-
16	16	M3×0.5	4	7	M5×0.8	30.6	8	25(30)	8 <sup>±0.05</sup>	13	ø2H9 $\nabla$ 3	23.6 <sup>±0.05</sup>	6.5 <sup>±0.02</sup>	11 <sup>±0.02</sup>	22	15	11.6	2.1	5.8
20	18.6	M4×0.7	5	9	M5×0.8	42	10	30(36)	10 <sup>±0.05</sup>	15	ø4H9 $\nabla$ 4	27.6 <sup>±0.05</sup>	7.5 <sup>±0.02</sup>	16.8 <sup>±0.02</sup>	32	18	14	2.1	9
25	22	M5×0.8	6	12	M5×0.8	52	10	33(43)	12 <sup>±0.05</sup>	20	ø4H9 $\nabla$ 4	33.6 <sup>±0.05</sup>	10 <sup>±0.02</sup>	21.8 <sup>±0.02</sup>	40	22	19	3.5	11.5

注) ( ) 内的尺寸为单位的尺寸

### Y 型夹 Y Type Gripper



型号(Model)	S	GMHC2-16S	GMHC2-20S
	D	GMHC2-16D	GMHC2-20D
缸径 Bore	16		20
使用流体 Fluid	空气 Air		
使用压力 范围(MPa) Operating pressure range	单作用 Single action	0.1~0.6	
	双作用 Double action	0.25~0.6	
环境及流体温度 Environment and fluid temperature	-10~60℃		
最高使用频率(c.p.m) Maximum frequency of use	180c.p.m		
重复精度(mm) Repeatability accuracy	±0.01		
重量(Weight)	S	99g	167g
	D	108g	177g

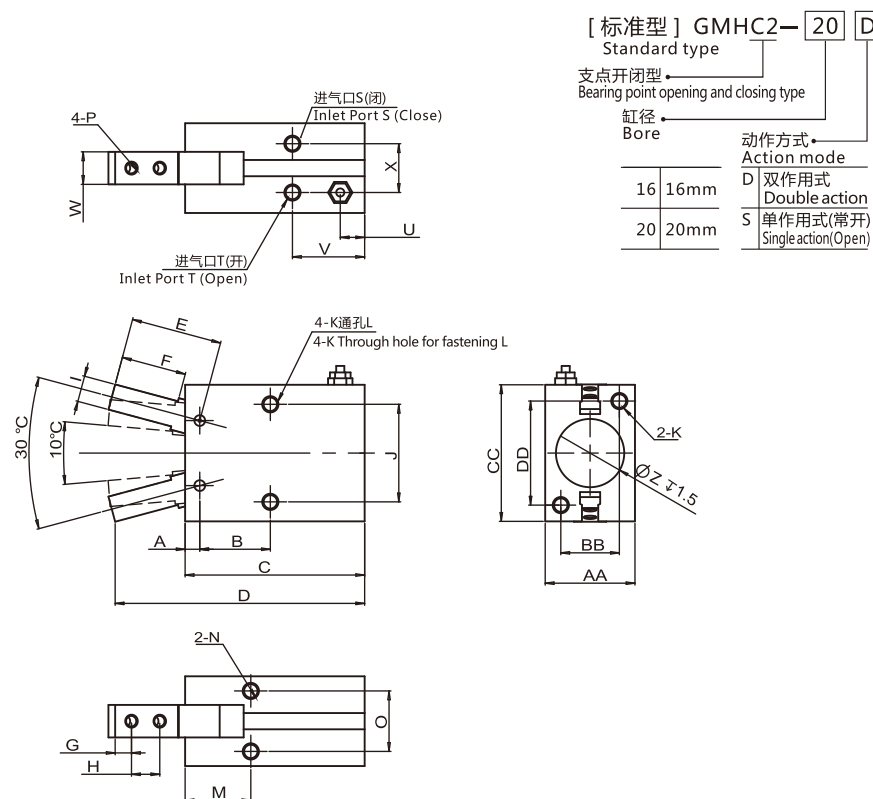

缸径 (Bore (mm)	A	B	C	D	E	F	G	H	I	J	K	L	M	N	O	P	接管口径 Pipe Size S T	U	V	W	X	Z	AA	BB	CC	DD
16	3.9	16.2	44.6	62.5	22.6	16	4	7	7	24	M4X0.7 18	3.4	10.7	M4×0.7 18	16	M3×0.5	M5×0.8	7	18.3	8	13	17	23.6	15	30.6	22
20	4.5	21.7	55.2	78.7	28	20	5.2	9	8	30	M5X0.8 10	4.3	15.7	M5×0.8 18	8.6	M4×0.7	M5×0.8	7.5	22.2	10	15	21	27.6	18	42	32

开关选择请参考P230页

### 三爪夹 Three Jaws Gripper



型号(Model)		GMHS3-16D	GMHS3-20D	GMHS3-25D
缸径 Bore		16	20	25
使用流体 Fluid		空气 Air		
使用压力范围 Operating pressure range		0.2~0.6MPa		
环境及流体温度 Environment and fluid temperature		-10~60℃		
重复精度(mm) Repeatability accuracy		±0.01		
最高使用频率(c.p.m) Maximum frequency of use		120c.p.m		
动作方式 action mode		双作用 Double action		
注)夹持力N 压力0.5MPa	外径夹持 External diameter clamping	14	25	42
	内径夹持 Internal diameter clamping	16	28	47
Note) gripping force N Pressure 0.5MPa	带防尘罩外径夹持 External diameter clamping with dust cover	9	21	36
带罩·标准型手指行程 Standard finger stroke with hood		4	4	6
长行程手指行程 Long stroke finger stroke		10	10	12
接管口径Rc Pipe Size		M3×0.5	M5×0.8	
磁性开关 Magnetic switch		内置磁环型 Built in magnetic ring type		
重量 Weight		59g	96.7g	138g

注)夹持外径时的夹持力, Ø16-Ø25的夹持点距离L=20mm时的数值  
Note) Clamping force when holding the outside diameter,  
The value of the holding point of Ø16-Ø25 is L=20mm

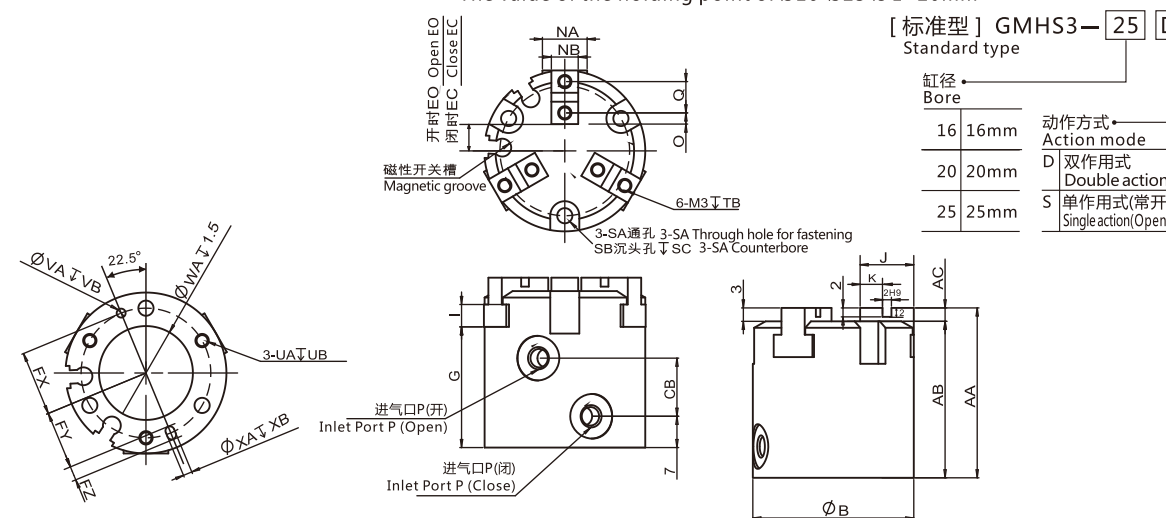

缸径(Bore)	AA	AB	B	CB	EC	EO	FX	FY	FZ	G	I	J	K	NA	NB
16	35	32	30	11	5	7	12.5	11	3	25	4	10	4	8	5h9
20	38	35	36	13	6	8	14.5	13	3	27	5	12	5	10	6h9
25	40	37	42	15	7	10	17	14.5	5	28	5	14	6	12	6h9

缸径(Bore)	O	P	Q	SA	SB	SC	TB	UA	UB	VA	VB	WA	XA	XB
16	2	M3×0.5	6	3.4	6.5	8	5	M3×0.5	4.5	2H9	2	17H9	2H9	2
20	2.5	M5×0.8	7	3.4	6.5	9.5	6	M3×0.5	6	2H9	2	21H9	2H9	2
25	3	M5×0.8	8	4.5	8	10	6	M4×0.7	6	3H9	3	26H9	3H9	3



## 水口夹具 Sprue Gripper

本体使用超硬铝材料，重量轻刚性强，寿命长。  
组装时可选择螺纹安装和LADUNG 部品安装。

Main body being made of high-strength Aluminium, light weight, strong rigidity and long life cycle.  
Using threaded components or LADUNG components when to assemble.

水口夹具GE(S/M/L/X)系列 (无传感器)  
Series GE-Sprue Gripper (Without Sensor)



水口夹具GE(S/M/L/X)系列 (带传感器)  
Series GE -Sprue Gripper (With Sensor)



型号(Model)	信号开关(Switch type)	抓取力(F)	重量(Weight)
GES08	-	5N	18g
GES08-N	NPN	5N	40g
GES08-P	PNP	5N	40g
GEM12A	-	28N	46g
GEM12A-N	NPN	28N	60g
GEM12A-P	PNP	28N	60g
GEM12B	-	28N	46g
GEM12B-N	NPN	28N	60g
GEM12B-P	PNP	28N	60g
GEL12A	-	45N	94g
GEL12A-N	NPN	45N	100g
GEL12A-P	PNP	45N	100g
GEX20	-	80N	180g
GEX20-N	NPN	80N	192g
GEX20-P	PNP	80N	192g

## 水口夹具 Sprue Gripper

运用实例 / Application example

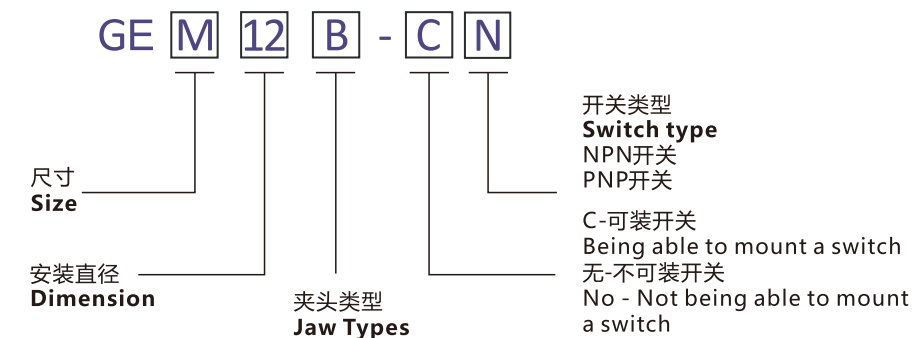
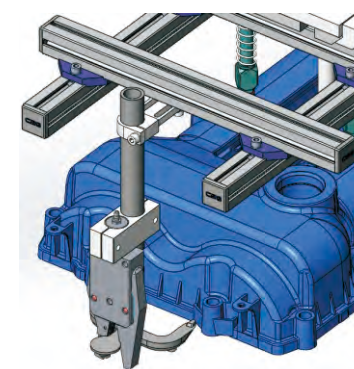

## 安装方式 / Installation method

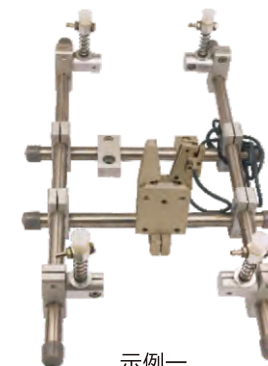

示例一  
Application example 1



示例二  
Application example 2

## 选配件 / Accessorier selection



接近传感器  
Sensor  
1.PNP  
2.NPN

型号(Model)	
LAD-06DN01-P	PNP
LAD-06DN01-N	NPN

注：线长为2米  
Note: The length is 2 meters

## 开关接线说明/Switch wiring instructions

## NPN输出型 / NPN output type

输入、输出电路图  
Input and output circuit diagrams

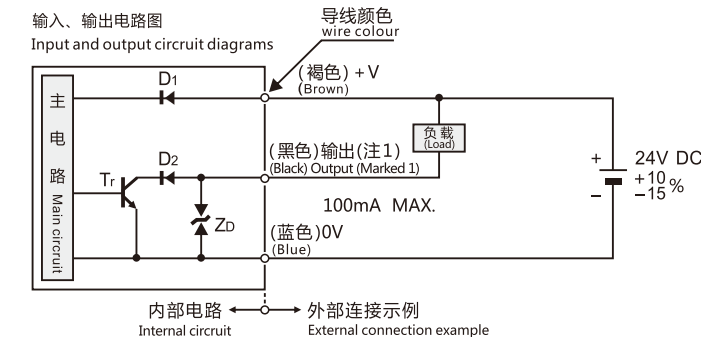

(注1): 输出未装备短路保护电路。请勿直接连接电源或容性负载。  
(Marked 1) Output is not equipped with short-circuit protection circuit.  
Do not connect directly to power or capacitive loads

## PNP输出型/ PNP output type

输入、输出电路图  
Input and output circuit diagrams

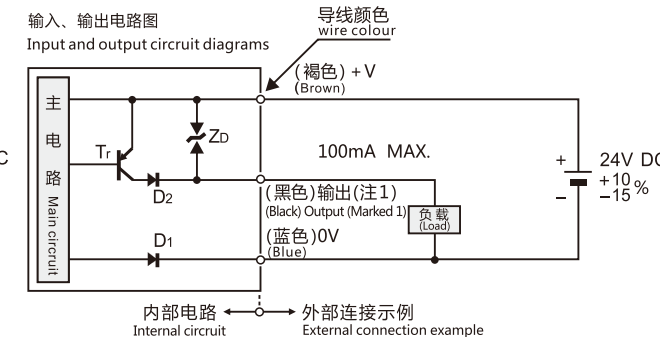

(注1): 输出未装备短路保护电路。请勿直接连接电源或容性负载。  
(Marked 1) Output is not equipped with short-circuit protection circuit.  
Do not connect directly to power or capacitive loads

## 水口夹具GES08系列 Sprue Gripper GES08 Series



GES08  
无传感器 (Without Sensor)



GES08-N(P)  
带传感器 (With Sensor)

### 产品描述 Product Description

GES08系列  
本体使用超硬铝材料，重量轻刚性强，寿命长。  
组装时可选择螺纹安装和LADUNG部品安装。

#### Series GES08

Main body being made of high-strength Aluminium , light weight , strong rigidity and long life cycle  
Using threaded components or LADUNG's components when to assemble.

型号(Model)	传感器(Sensor)	抓取力(F)	重量(Weight)
GES08	-	5N	18g
GES08-N	NPN	5N	40g
GES08-P	PNP	5N	40g

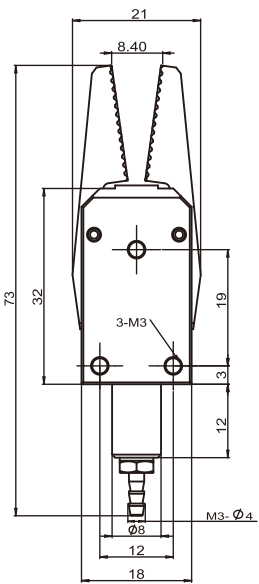

无传感器(Without Sensor)

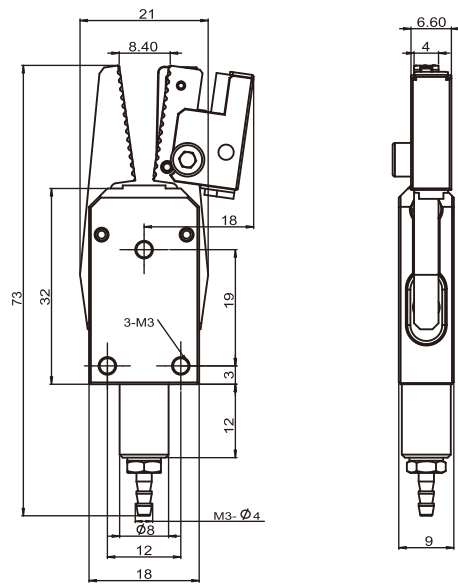

带传感器(With Sensor)

## 水口夹具GEM12系列 Sprue Gripper GEM12Series



GEM12A  
无传感器 (Without Sensor)



GEM12A-N(P)  
带传感器 (With Sensor)

### 产品描述 Product Description

#### GEM12系列

本体使用超硬铝材料，重量轻刚性强，寿命长。  
组装时可选择螺纹安装和LADUNG部品安装。

#### Series GEM12

Main body being made of high-strength Aluminium , light weight , strong rigidity and long life cycle  
Using threaded components or LADUNG's components when to assemble.

型号(Model)	传感器(Sensor)	抓取力(F)	重量(Weight)
GEM12A	-	28N	46g
GEM12B	-	28N	46g
GEM12A-N	NPN	28N	60g
GEM12A-P	PNP	28N	60g
GEM12B-N	NPN	28N	60g
GEM12B-P	PNP	28N	60g

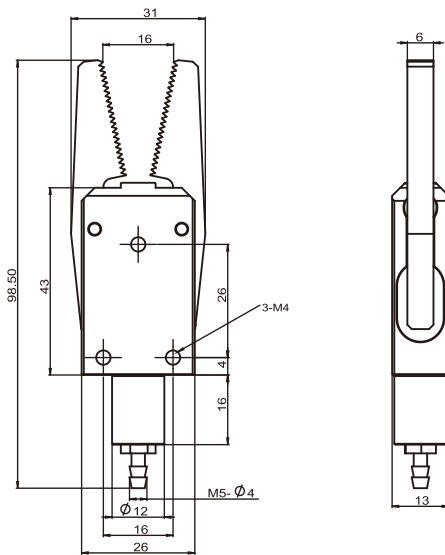

无传感器(Without Sensor)

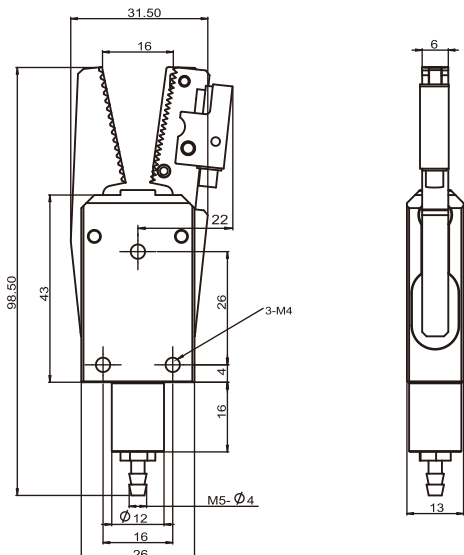

带传感器(With Sensor)



水口夹具GEL12系列 Sprue Gripper GEL12 Series



GEL12A  
无传感器 (Without Sensor)



GEL12A-N(P)  
带传感器 (With Sensor)

产品描述 Product Description

GEL12系列

本体使用超硬铝材料，重量轻刚性强，寿命长。  
组装时可选择螺纹安装和LADUNG部品安装。

Series GEL12

Main body being made of high-strength Aluminium , light weight , strong rigidity and long life cycle  
Using threaded components or LADUNG's components when to assemble.

型号(Model)	传感器(Sensor)	抓取力(F)	重量(Weight)
GEL12A	-	45N	94g
GEL12A-N	NPN	45N	100g
GEL12A-P	PNP	45N	100g

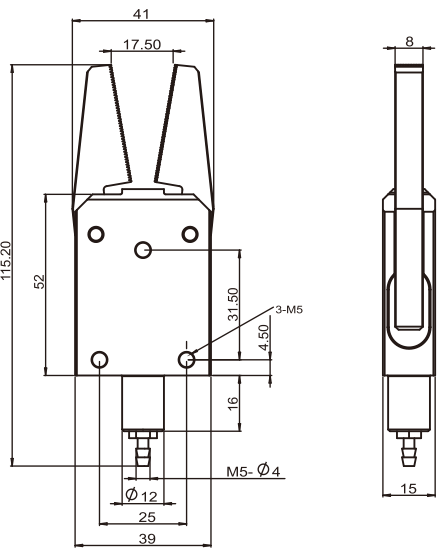

无传感器(Without Sensor)

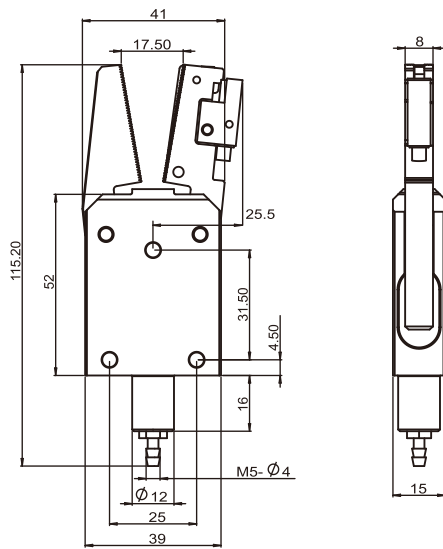

带传感器(With Sensor)

水口夹具GEX20系列 Sprue Gripper GEX20 Series



GEX20  
无传感器 (Without Sensor)



GEX20-N(P)  
带传感器 (With Sensor)

产品描述 Product Description

GEX20系列

本体使用超硬铝材料，重量轻刚性强，寿命长。  
组装时可选择螺纹安装和LADUNG部品安装。

Series GEX20

Main body being made of high-strength Aluminium , light weight , strong rigidity and long life cycle  
Using threaded components or LADUNG's components when to assemble.

型号(Model)	传感器(Sensor)	抓取力(F)	重量(Weight)
GEX20	-	80N	180g
GEX20-N	NPN	80N	192g
GEX20-P	PNP	80N	192g

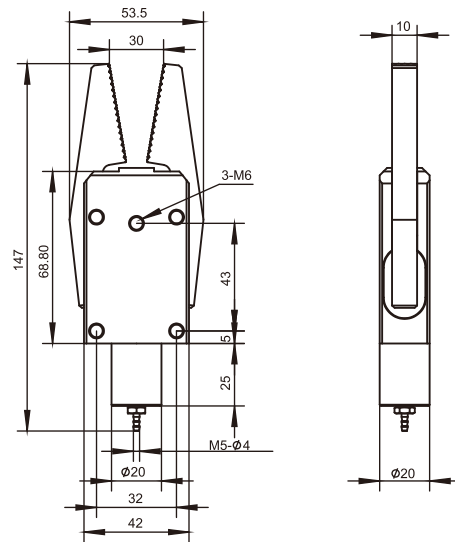

无传感器(Without Sensor)

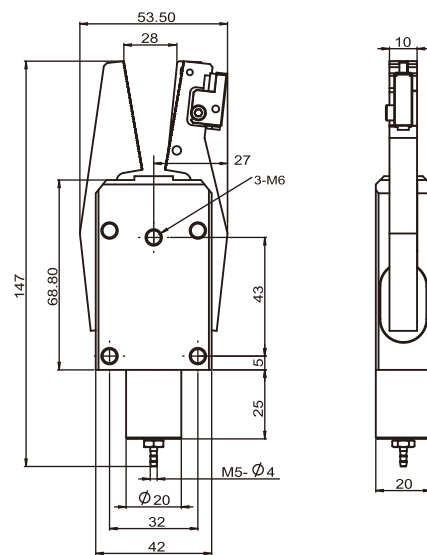

带传感器(With Sensor)

水口夹具GE12系列 Sprue Gripper GE12 Series

型号表示方法  
Model representation methods

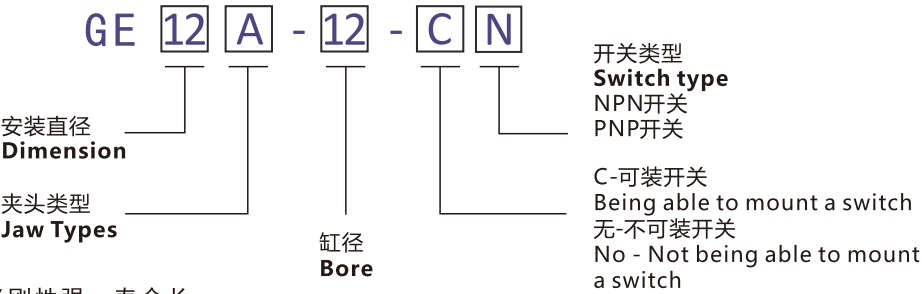

本体使用超硬铝材料，重量轻刚性强，寿命长。  
组装时可选择螺纹安装和LADUNG部品安装。

Main body being made of high-strength Aluminium , light weight , strong rigidity and long life cycle  
Using threaded components or LADUNG's components when to assemble.



GE10A-12  
GE12A-12  
GE12M-12(钢制钳口)  
无传感器 (Without Sensor)



GE12B-12  
无传感器  
(Without Sensor)



GE12L-12  
无传感器  
(Without Sensor)



GE10N-12  
无传感器  
(Without Sensor)

选配件 / Accessorier selection



GE10A-12-P  
GE12A-12-N(P)  
GE12M-12-N(P)(钢制钳口)  
带传感器 (Without Sensor)



GE12B-12-N(P)  
带传感器  
(Without Sensor)



开关  
1.PNP  
2.NPN

型号(Model)
MAP-8S2P1/F(PNP)
MAP-8S2N1/F(NPN)

注：线长为1米  
Note: The length is 1 meters

型号(Model)	传感器(Sensor)	抓取力(F)	重量(Weight)
GE05A-10	-	12N	9.6g
GE10A-12	-	28N	44g
GE10A-12-P	PNP	28N	70g
GE10A-12-N	NPN	28N	70g
GE10D-12	-	28N	42g
GE10D-12-P	PNP	28N	61g
GE10D-12-N	NPN	28N	61g
GE12A-12	-	28N	44g
GE12A-12-P	PNP	28N	70g
GE12A-12-N	NPN	28N	70g
GE12B-12	-	28N	44g
GE12B-12-P	PNP	28N	70g
GE12B-12-N	NPN	28N	70g
GE10L-12	-	28N	50g
GE12L-12	-	28N	50g
GE12M-12	-	28N	66.2g
GE12M-12-P	PNP	28N	82.5g
GE12M-12-N	NPN	28N	82.5g

GE05A系列 GE05A Series

产品描述  
Product Description

GE05A系列  
本体使用超硬铝材料，重量轻刚性强，寿命长。  
组装时可选择螺纹安装和LADUNG部品安装。

Series GE05A  
Main body being made of high-strength Aluminium , light weight , strong rigidity and long life cycle  
Using threaded components or LADUNG's components when to assemble.



锯齿  
Jagged

GE05A-10  
无传感器(Without Sensor)

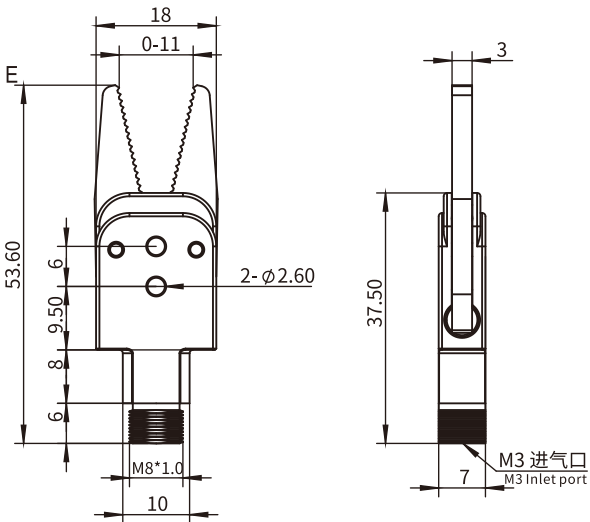

型号(Model)	传感器(Sensor)	抓取力(F)	重量(Weight)
GE05A-10	-	12N	9.6g

## 水口夹具GE10系列 Sprue Gripper GE10 Series



GE10A-12  
无传感器 (With Sensor)



钻石齿  
Diamond tooth

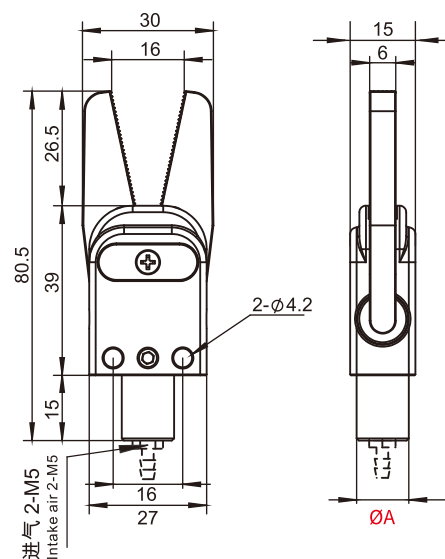

GE10A-12-N(P)  
带传感器 (With Sensor)

MAP-8S2P1/F(PNP)  
MAP-8S2N1/F(NPN)

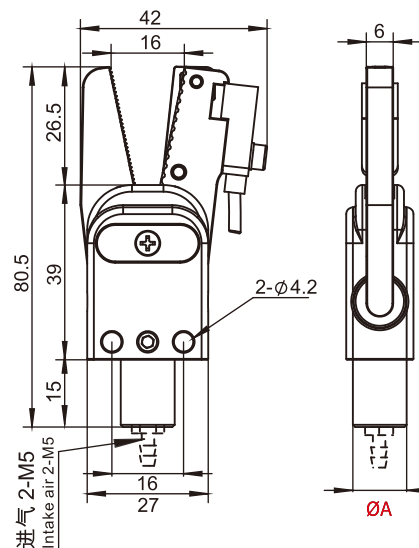

型号(Model)	A	传感器(Sensor)	抓取力(F)	重量(Weight)
GE10A-12	Ø10	-	28N	44g
GE10A-12-P	Ø10	PNP	28N	70g
GE10A-12-N	Ø10	NPN	28N	70g
GE12A-12	Ø12	-	28N	44g
GE12A-12-P	Ø12	PNP	28N	70g
GE12A-12-N	Ø12	NPN	28N	70g

## 水口夹具GE10系列 Sprue Gripper GE10 Series



GE10D-12  
无传感器 (Without Sensor)



斜齿  
Helical tooth

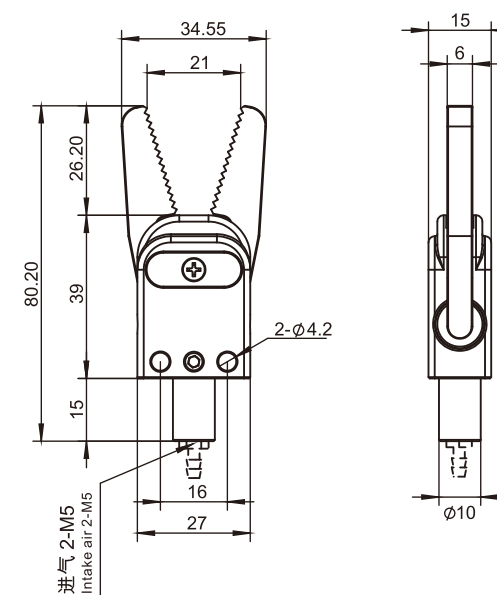

GE10D-12-P  
带传感器 (Without Sensor)

MAP-8S2P1/F(PNP)  
MAP-8S2N1/F(NPN)

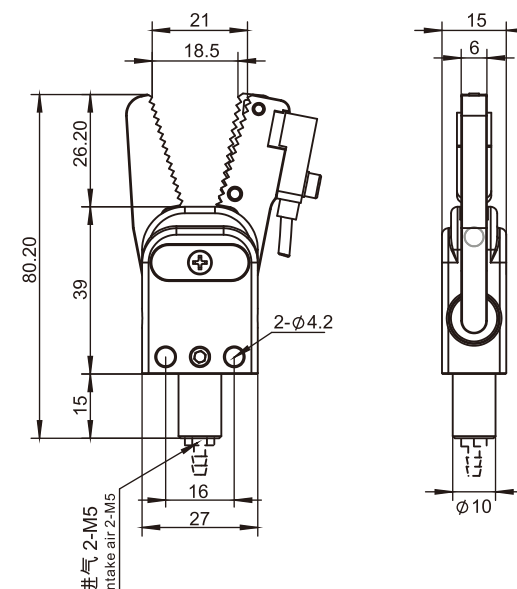

型号(Model)	传感器(Sensor)	抓取力(F)	重量(Weight)
GE10D-12	-	28N	42g
GE10D-12-P	PNP	28N	61g
GE10D-12-N	NPN	28N	61g



# 水口夹具GE12系列 Sprue Gripper GE12 Series

气动剪刀

微型气剪

型材、钢棒

支架模组

快换

夹具组件

真空组件

附件



GE12B-12  
无传感器 (Without Sensor)



斜齿  
Helical tooth

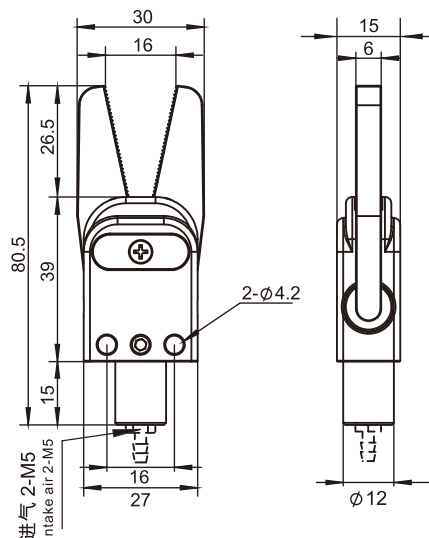

GE12B-12-N(P)  
无传感器 (Without Sensor)

MAP-8S2P1/F(PNP)  
MAP-8S2N1/F(NPN)

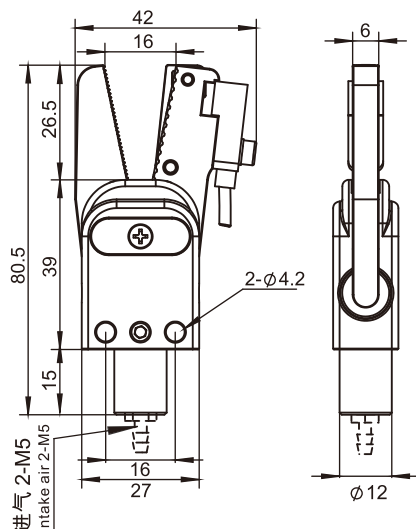

型号(Model)	传感器(Sensor)	抓取力(F)	重量(Weight)
GE12B-12	-	28N	44g
GE12B-12-P	PNP	28N	70g
GE12B-12-N	NPN	28N	70g

# 水口夹具GE12系列 Sprue Gripper GE12 Series

气动剪刀

微型气剪

型材、钢棒

支架模组

快换

夹具组件

真空组件

附件



GE12L-12  
无传感器 (Without Sensor)

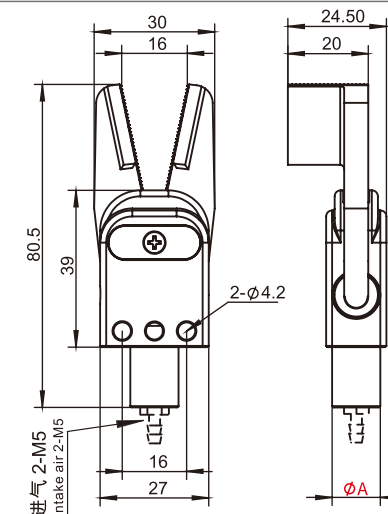

型号(Model)	A	传感器(Sensor)	抓取力(F)	重量(Weight)
GE10L-12	Ø10	-	28N	50g
GE12L-12	Ø12	-	28N	50g



GE10N-12  
无传感器 (Without Sensor)

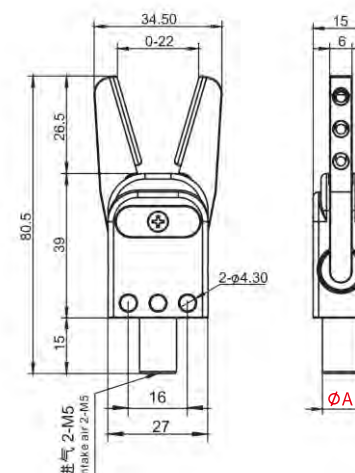

型号(Model)	A	传感器(Sensor)	抓取力(F)	重量 (Weight)
GE10N-12	Ø10	-	28N	42g
GE12N-12	Ø12	-	28N	42g



GE12N-12-N  
带传感器 (With Sensor)

MAP-8S2P1/F(PNP)  
MAP-8S2N1/F(NPN)

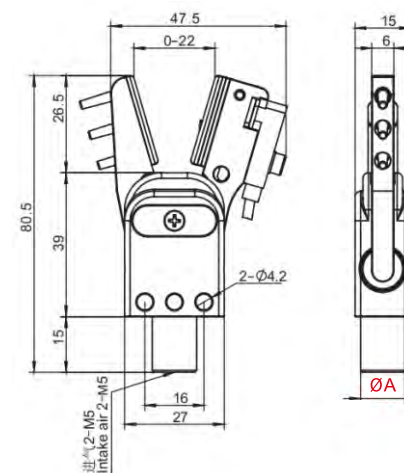

型号(Model)	A	传感器(Sensor)	抓取力(F)	重量 (Weight)
GE10N-12-N	Ø10	NPN	28N	74.3g
GE10N-12-P	Ø10	PNP	28N	74.3g
GE12N-12-N	Ø12	NPN	28N	74.3g
GE12N-12-P	Ø12	PNP	28N	74.3g

水口夹具GE12系列 Sprue Gripper GE12 Series

NEW



钢制钳口  
Steel jaw

GE12M-12  
无传感器 (Without Sensor)

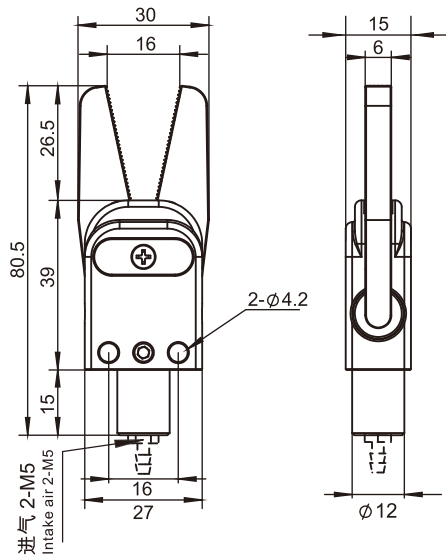

NEW



MAP-8S2P1/F(PNP)  
MAP-8S2N1/F(NPN)

GE12M-12-N(P)  
无传感器 (Without Sensor)

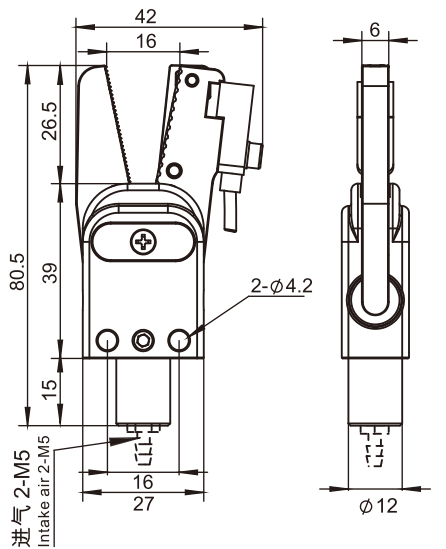

型号(Model)	传感器(Sensor)	抓取力(F)	重量(Weight)
GE12M-12	-	28N	66.2g
GE12M-12-P	PNP	28N	82.5g
GE12M-12-N	NPN	28N	82.5g

水口夹具GE20系列 Sprue Gripper GE20 Series

1. 本体使用超硬铝材料，重量轻刚性强，寿命长。
2. 组装时可选择螺纹安装和LADUNG部品安装。
3. GE系列水口夹可选择不同的夹头形状，满足多种水口的夹取。
1. Main body being made of high-strength Aluminium, light weight, strong rigidity and long life cycle.
2. Using threaded components or LADUNG's components when to assemble.
3. GE series of sprue gripper can choose different types of jaws to satisfy the clamping of various sprue gate.



GE20A-20  
无传感器  
(Without Sensor)



GE20B-20  
无传感器  
(Without Sensor)



GE20C-20  
无传感器  
(Without Sensor)



GE20D-20  
无传感器  
(Without Sensor)



GE20A-20-N(P)  
带传感器  
(With Sensor)



GE20B-20-N(P)  
带传感器  
(With Sensor)



GE20D-20-N(P)  
带传感器  
(With Sensor)



GE20E-20  
无传感器  
(Without Sensor)

型号(Model)	传感器(Sensor)	抓取力(F)	重量(Weight)
GE20A-20	-	80N	112g
GE20A-20-P	PNP	80N	137g
GE20A-20-N	NPN	80N	137g
GE20B-20	-	80N	112g
GE20B-20-P	PNP	80N	137g
GE20B-20-N	NPN	80N	137g
GE20C-20	-	80N	140g
GE20D-20	-	80N	149g
GE20D-20-P	PNP	80N	173.1g
GE20D-20-N	NPN	80N	173.1g
GE20E-20	-	80N	129g



## 水口夹具GE20系列 Sprue Gripper GE20 Series

1. 本体使用超硬铝材料，重量轻刚性强，寿命长。
  2. 组装时可选择螺纹安装和LADUNG 部品安装。
  3. GE系列水口夹可选择不同的夹头形状，满足多种水口的夹取。
1. Main body being made of high-strength Aluminium, light weight, strong rigidity and long life cycle.
  2. Using threaded components or LADUNG's components when to assemble.
  3. GE series of sprue gripper can choose different types of jaws to satisfy the clamping of various sprue gate.



GE20G-20  
无传感器  
(Without Sensor)



GE20H-20  
无传感器  
(Without Sensor)



GE20I-20  
无传感器  
(Without Sensor)



GE20F-20  
无传感器  
(Without Sensor)



GE20G-20-N(P)  
带传感器  
(With Sensor)



GE20H-20-N(P)  
带传感器  
(With Sensor)



GE20I-20-N(P)  
带传感器  
(With Sensor)

型号(Model)	传感器(Sensor)	抓取力(F)	重量(Weight)
GE20F-20	-	80N	128g
GE20G-20	-	80N	131.1g
GE20G-20-P	PNP	80N	153.7g
GE20G-20-N	NPN	80N	153.7g
GE20H-20	-	80N	193.1g
GE20H-20-P	PNP	80N	220.5g
GE20H-20-N	NPN	80N	220.5g
GE20I-20	-	80N	191.6g
GE20I-20-P	PNP	80N	219g
GE20I-20-N	NPN	80N	219g

## 水口夹具GE20系列 Sprue Gripper GE20 Series



GE20A-20  
无传感器 (Without Sensor)



钻石齿  
Diamond tooth

底部四个螺丝为了方便接气，  
出厂时为松动状态。  
The four screws on the bottom  
are loose for ventilate conveniently  
when they leaving the factory

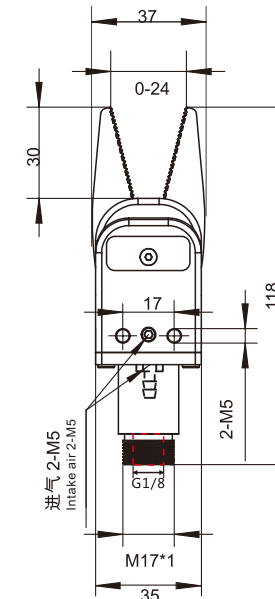
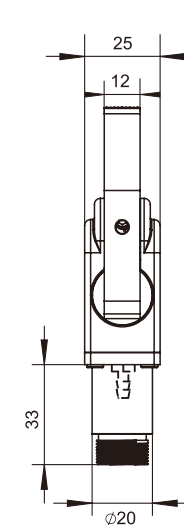

GE20A-20-N(P)  
带传感器 (With Sensor)

MAP-8S2P1/F(PNP)  
MAP-8S2N1/F(NPN)

底部四个螺丝为了方便接气，  
出厂时为松动状态。  
The four screws on the bottom  
are loose for ventilate conveniently  
when they leaving the factory

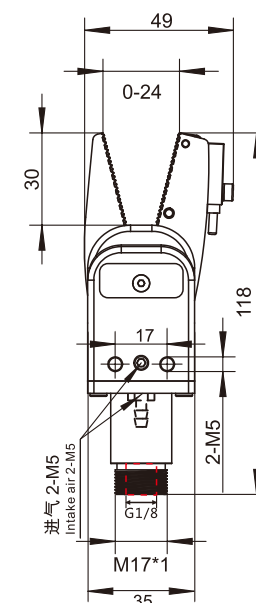
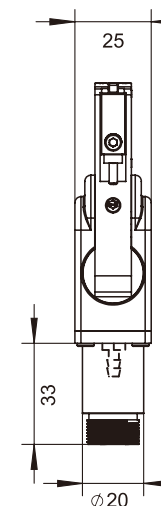

型号(Model)	传感器(Sensor)	抓取力(F)	重量(Weight)
GE20A-20	-	80N	112g
GE20A-20-P	PNP	80N	137g
GE20A-20-N	NPN	80N	137g



水口夹具GE20系列 Sprue Gripper GE20 Series

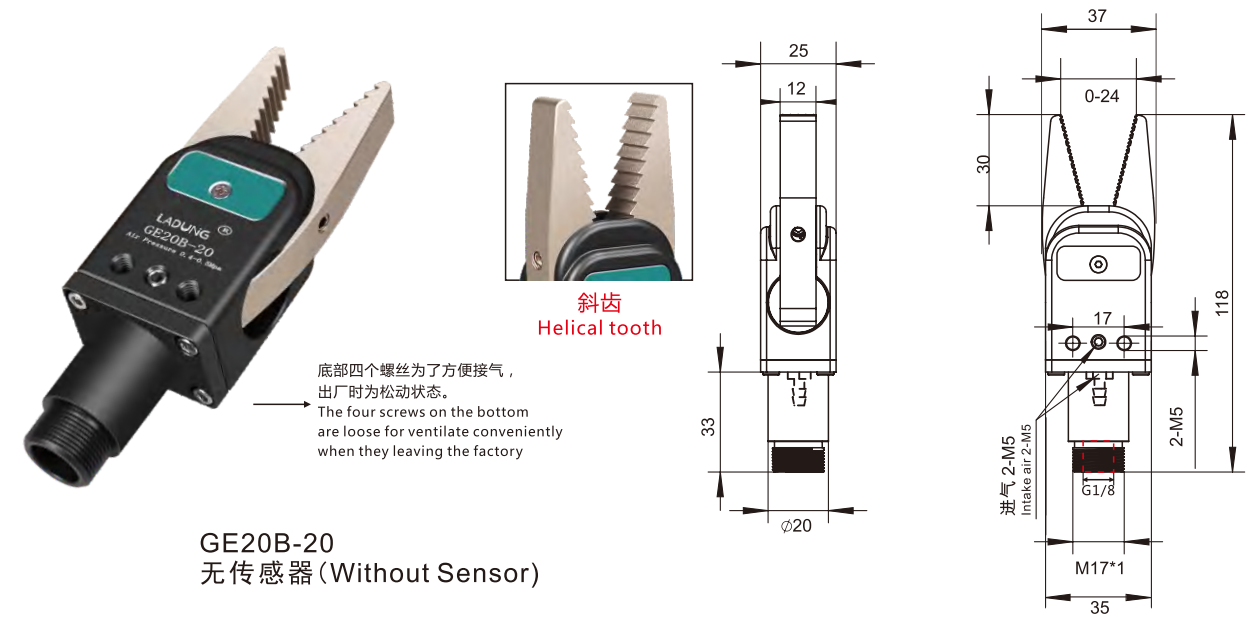

GE20B-20  
无传感器 (Without Sensor)

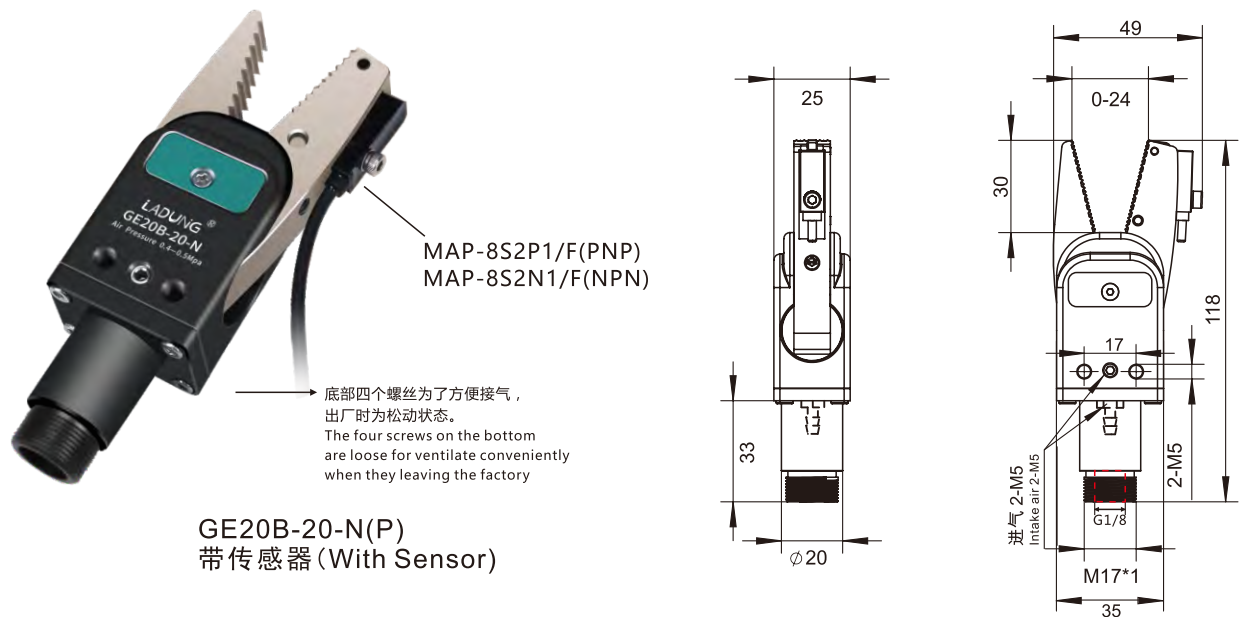

GE20B-20-N(P)  
带传感器 (With Sensor)

型号(Model)	传感器(Sensor)	抓取力(F)	重量(Weight)
GE20B-20	-	80N	112g
GE20B-20-P	PNP	80N	137g
GE20B-20-N	NPN	80N	137g

水口夹具GE20系列 Sprue Gripper GE20 Series

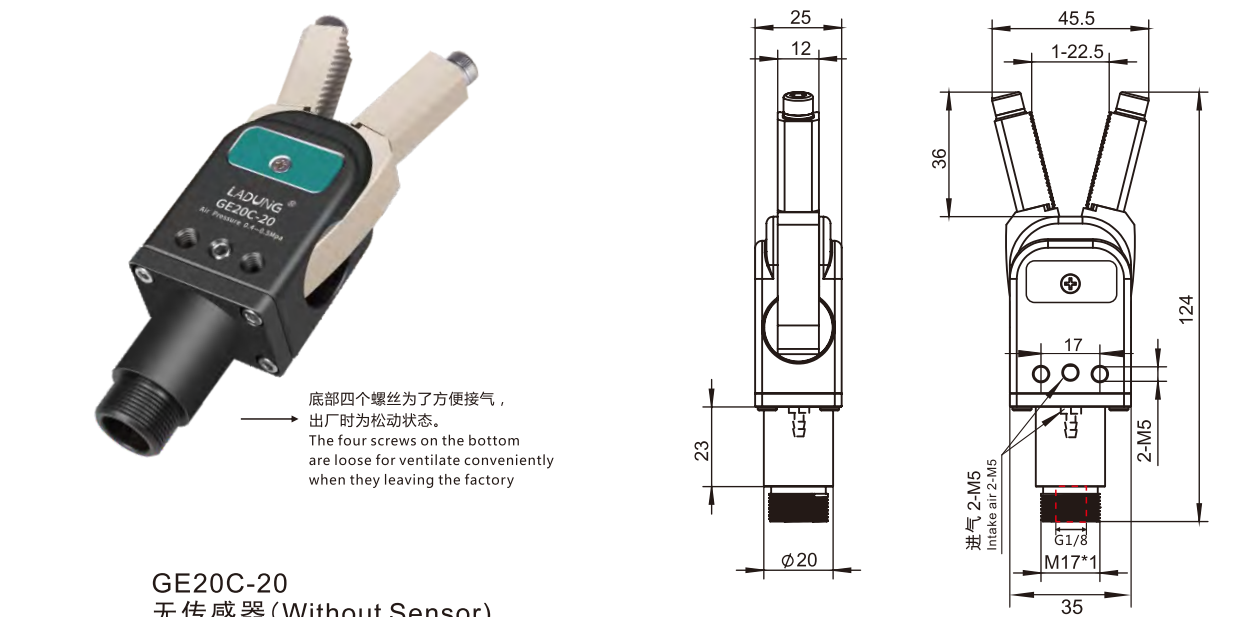

GE20C-20  
无传感器 (Without Sensor)

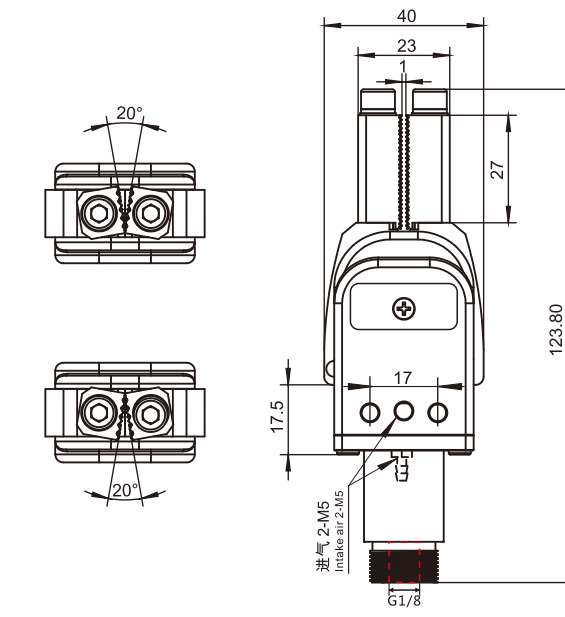

型号(Model)	传感器(Sensor)	抓取力(F)	重量(Weight)
GE20C-20	-	80N	140g

水口夹具GE20系列 Sprue Gripper GE20 Series



底部四个螺丝为了方便接气，  
出厂时为松动状态。  
The four screws on the bottom  
are loose for ventilate conveniently  
when they leaving the factory

GE20D-20  
无传感器 (Without Sensor)

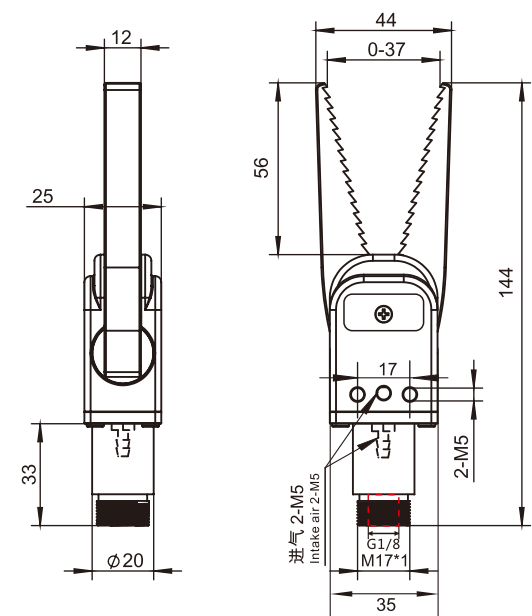

型号(Model)	传感器(Sensor)	抓取力(F)	重量(Weight)
GE20D-20	-	80N	149g



MAP-8S2P1/F(PNP)  
MAP-8S2N1/F(NPN)

底部四个螺丝为了方便接气，  
出厂时为松动状态。  
The four screws on the bottom  
are loose for ventilate conveniently  
when they leaving the factory

GE20D-20-N(P)  
带传感器 (With Sensor)

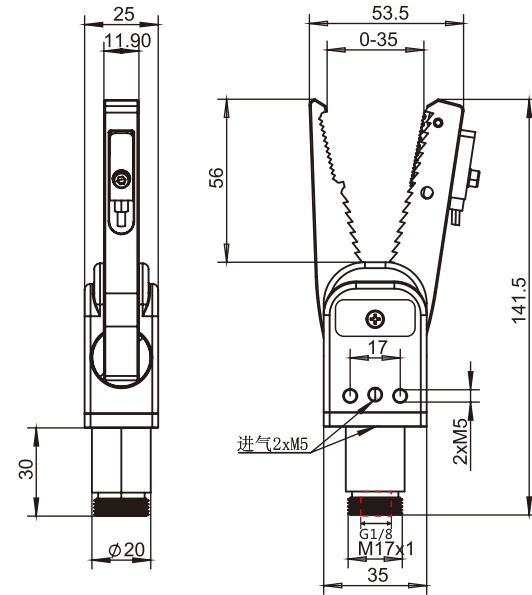

型号(Model)	传感器(Sensor)	抓取力(F)	重量(Weight)
GE20D-20	-	80N	149g
GE20D-20-P	PNP	80N	173.1g
GE20D-20-N	NPN	80N	173.1g

水口夹具GE20系列 Sprue Gripper GE20 Series



底部四个螺丝为了方便接气，  
出厂时为松动状态。  
The four screws on the bottom  
are loose for ventilate conveniently  
when they leaving the factory

GE20E-20  
无传感器 (Without Sensor)

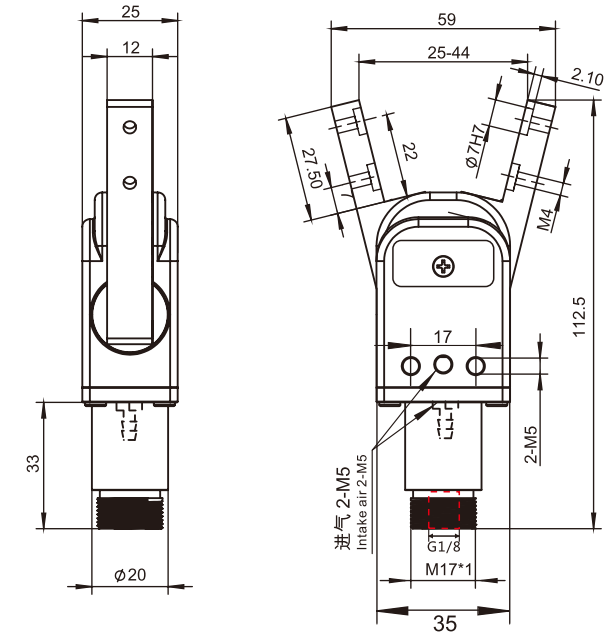

型号(Model)	传感器(Sensor)	抓取力(F)	重量(Weight)
GE20E-20	-	80N	129g



底部四个螺丝为了方便接气，  
出厂时为松动状态。  
The four screws on the bottom  
are loose for ventilate conveniently  
when they leaving the factory

GE20F-20  
无传感器 (Without Sensor)



SIL-1026

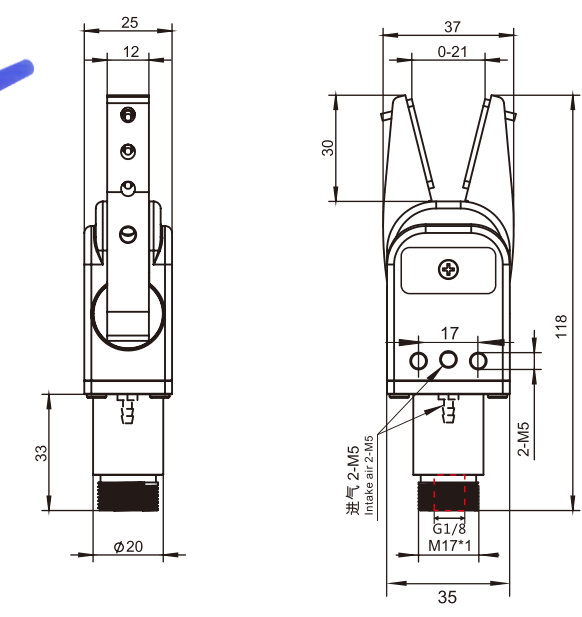

型号(Model)	传感器(Sensor)	抓取力(F)	重量(Weight)
GE20F-20	-	80N	128g
SIL-1026	-	-	1.7g

水口夹具GE20系列 Sprue Gripper GE20 Series

水口夹具GE20系列 Sprue Gripper GE20 Series

气动剪刀  
微型气剪  
型材、钢棒  
支架模组  
快换  
夹具组件  
真空组件  
附件

气动剪刀  
微型气剪  
型材、钢棒  
支架模组  
快换  
夹具组件  
真空组件  
附件



GE20G-20  
无传感器 (Without Sensor)

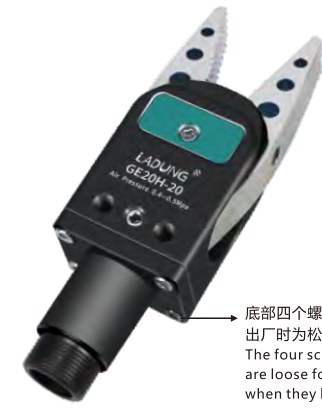
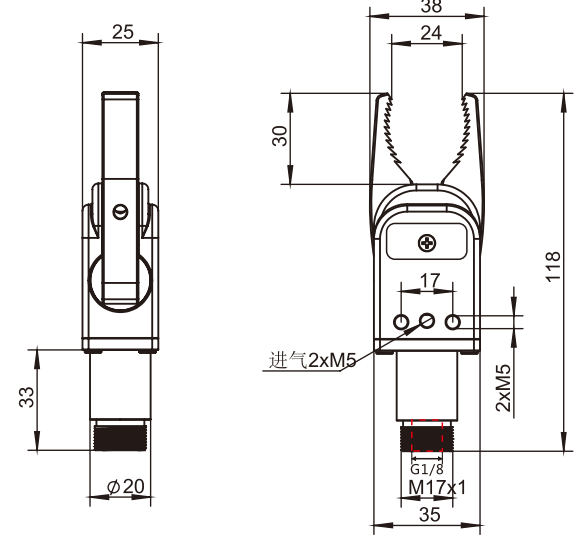

GE20H-20  
无传感器 (Without Sensor)

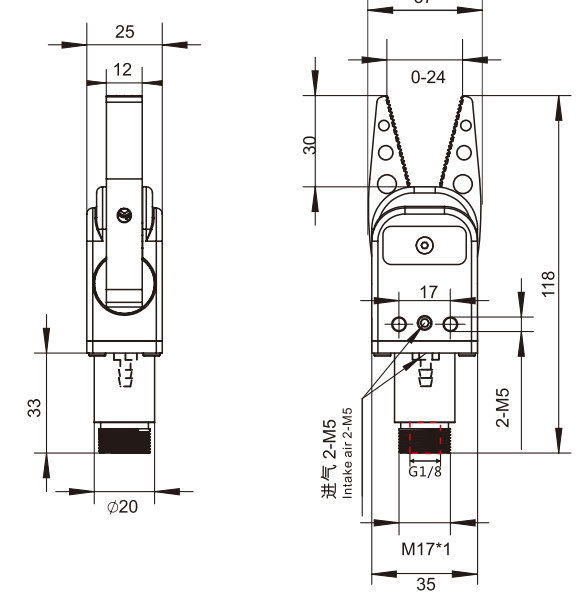

GE20G-20-N(P)  
带传感器 (With Sensor)

MAP-8S2P1/F(PNP)  
MAP-8S2N1/F(NPN)

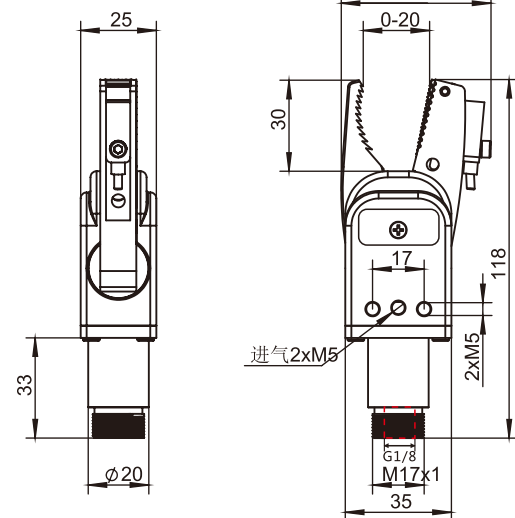

GE20H-20-N(P)  
带传感器 (With Sensor)

MAP-8S2P1/F(PNP)  
MAP-8S2N1/F(NPN)

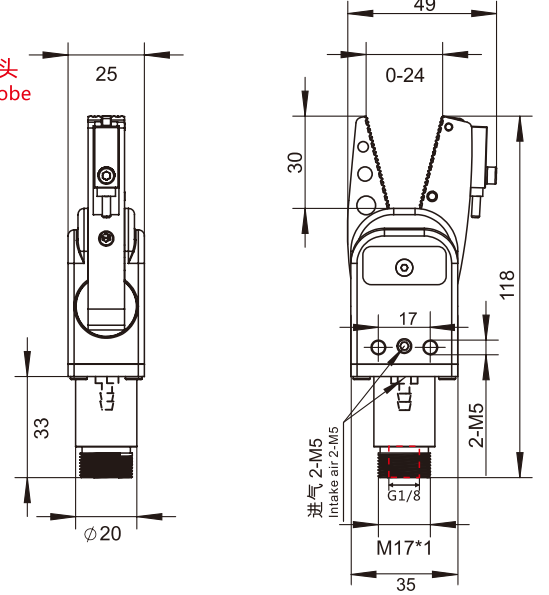
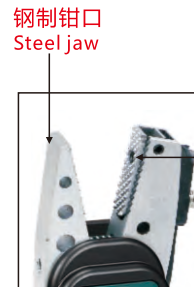

型号(Model)	传感器(Sensor)	抓取力(F)	重量(Weight)
GE20G-20	-	80N	131.1g
GE20G-20-P	PNP	80N	153.7g
GE20G-20-N	NPN	80N	153.7g

型号(Model)	传感器(Sensor)	抓取力(F)	重量(Weight)
GE20H-20	-	80N	193.1g
GE20H-20-P	PNP	80N	220.5g
GE20H-20-N	NPN	80N	220.5g



## 水口夹具GE20系列 Sprue Gripper GE20 Series



钢制钳口  
Steel jaw

底部四个螺丝为了方便接气，  
出厂时为松动状态。  
The four screws on the bottom  
are loose for ventilate conveniently  
when they leaving the factory

GE20I-20  
无传感器 (Without Sensor)

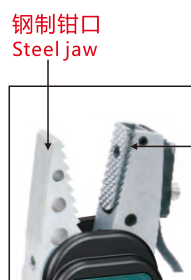
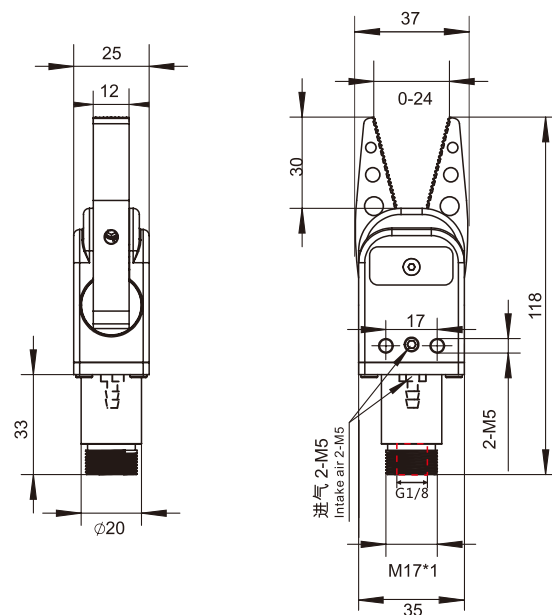

钢制钳口  
Steel jaw

MAP-8S2P1/F(PNP)  
MAP-8S2N1/F(NPN)

底部四个螺丝为了方便接气，  
出厂时为松动状态。  
The four screws on the bottom  
are loose for ventilate conveniently  
when they leaving the factory

GE20I-20-N(P)  
带传感器 (With Sensor)

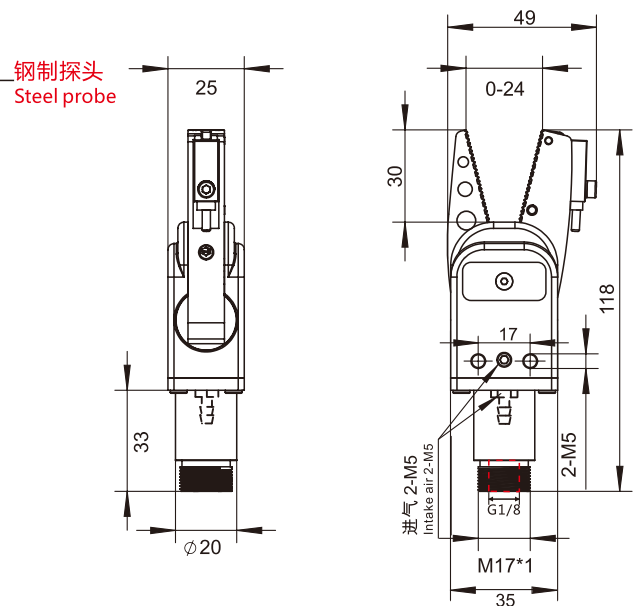

型号(Model)	传感器(Sensor)	抓取力(F)	重量(Weight)
GE20I-20	-	80N	191.6g
GE20I-20-P	PNP	80N	219.1g
GE20I-20-N	NPN	80N	219.1g

## 水口夹具GET20系列 Sprue Gripper GET20 Series

1. 本体使用超硬铝材料，重量轻刚性强，寿命长。
2. 组装时可选择螺纹安装和LADUNG 部品安装。
3. GE系列水口夹可选择不同的夹头形状，满足多种水口的夹取。
1. Main body being made of high-strength Aluminium, light weight, strong rigidity and long life cycle.
2. Using threaded components or LADUNG's components when to assemble.
3. GE series of sprue gripper can choose different types of jaws to satisfy the clamping of various sprue gate.



GET20A-N(P)  
带传感器  
(With Sensor)



GET20B-N(P)  
带传感器  
(With Sensor)



GET20G  
无传感器  
(Without Sensor)



GET20E-N(P)  
带传感器  
(With Sensor)



GET20A  
无传感器  
(Without Sensor)



GET20B  
无传感器  
(Without Sensor)



GET20D  
无传感器  
(Without Sensor)



GET20E  
无传感器  
(Without Sensor)

型号(Model)	信号开关(Switch type)	抓取力(F)	重量(Weight)
GET20A	-	100N	111g
GET20A-N	NPN	100N	130g
GET20A-P	PNP	100N	130g
GET20B	-	100N	162.8g
GET20B-N	NPN	100N	158.4g
GET20B-P	PNP	100N	158.4g
GET20G	-	100N	144g
GET20D	-	100N	160g
GET20D-N	NPN	100N	145g
GET20D-P	PNP	100N	145g
GET20E	-	100N	161g
GET20E-N	NPN	100N	165g
GET20E-P	PNP	100N	165g

水口夹具GET20系列 Sprue Gripper GET20 Series



GET20A  
无传感器 (Without Sensor)

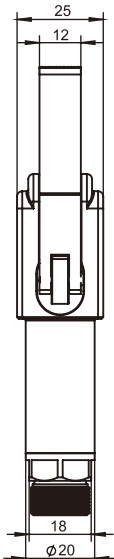
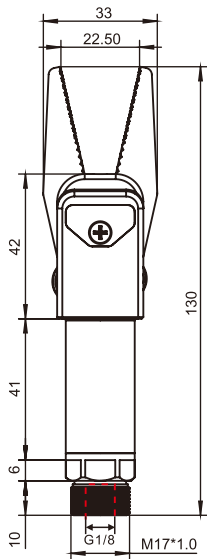

MAP-8S2P1/F(PNP)  
MAP-8S2N1/F(NPN)

GET20A-N(P)  
带传感器 (With Sensor)

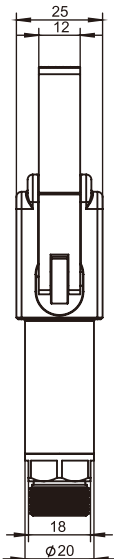
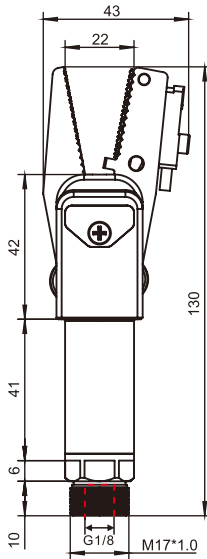

型号(Model)	传感器(Sensor)	抓取力(F)	重量(Weight)
GET20A	-	100N	111g
GET20A-N	NPN	100N	130g
GET20A-P	PNP	100N	130g

水口夹具GET20系列 Sprue Gripper GET20 Series



GET20B  
无传感器 (Without Sensor)

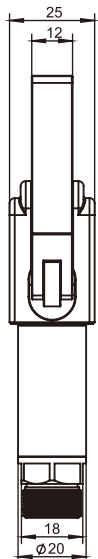
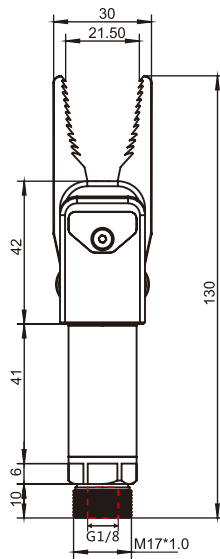

MAP-8S2P1/F(PNP)  
MAP-8S2N1/F(NPN)

GET20B-N(P)  
带传感器 (With Sensor)

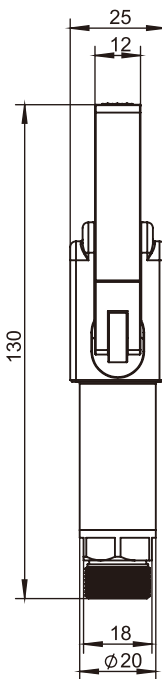
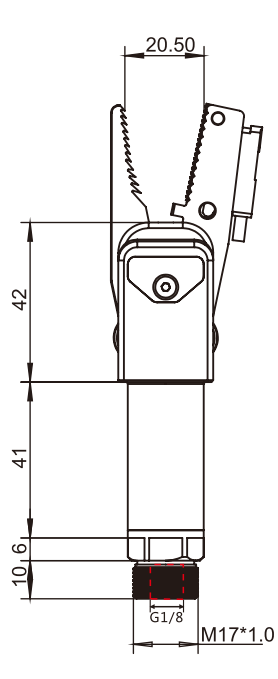

型号(Model)	传感器(Sensor)	抓取力(F)	重量(Weight)
GET20B	-	100N	162.8g
GET20B-N	NPN	100N	158.4g
GET20B-P	PNP	100N	158.4g

水口夹具GET20系列 Sprue Gripper GET20 Series

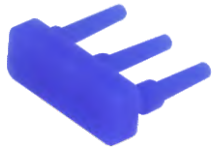

SIL-1026

GET20D  
无传感器 (Without Sensor)

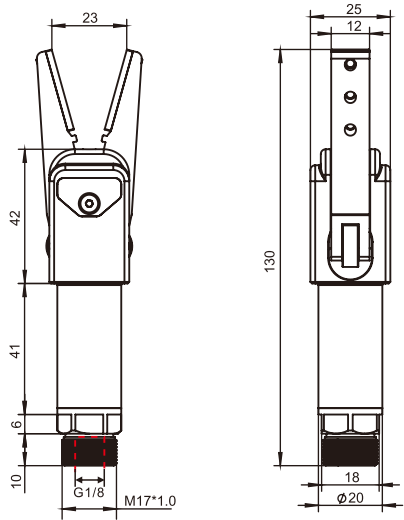

型号(Model)	传感器(Sensor)	抓取力(F)	重量(Weight)
GET20D	-	100N	160g



MAP-8S2P1/F(PNP)  
MAP-8S2N1/F(NPN)

GET20D-N  
带传感器 (With Sensor)

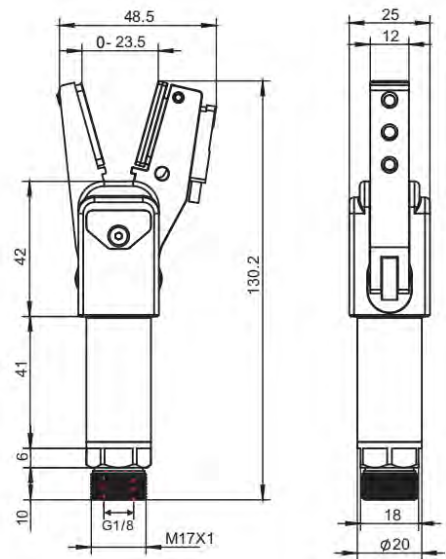

型号(Model)	传感器(Sensor)	抓取力(F)	重量(Weight)
GET20D-P	PNP	100N	145g
GET20D-N	NPN	100N	145g

水口夹具GET20系列 Sprue Gripper GET20 Series



GET20E  
无传感器 (Without Sensor)

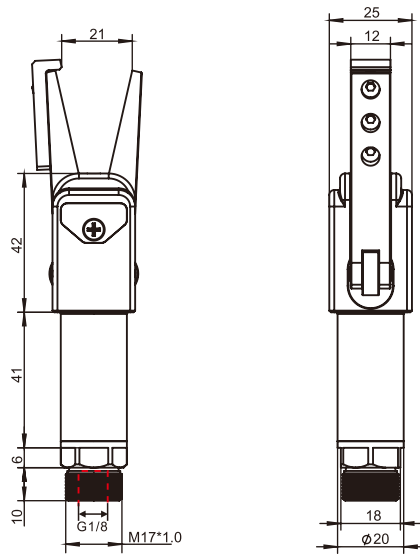

MAP-8S2P1/F(PNP)  
MAP-8S2N1/F(NPN)

GET20E-N(P)  
带传感器 (With Sensor)

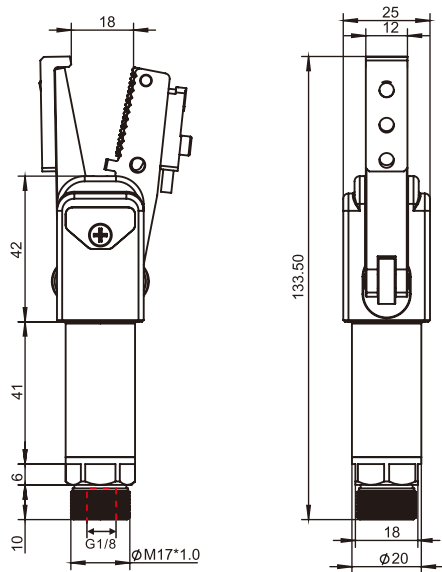

型号(Model)	传感器(Sensor)	抓取力(F)	重量(Weight)
GET20E	-	100N	161g
GET20E-N	NPN	100N	165g
GET20E-P	PNP	100N	165g



水口夹具GET20系列 Sprue Gripper GET20 Series



GET20G  
无传感器 (Without Sensor)

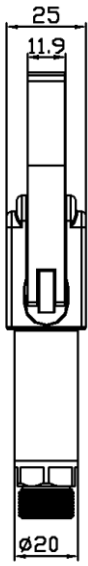
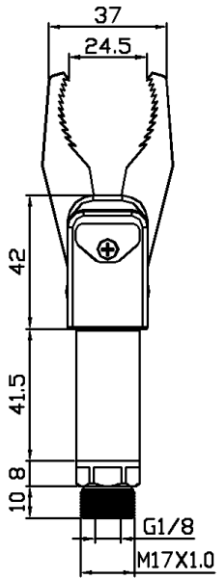

型号(Model)	传感器(Sensor)	抓取力(F)	重量(Weight)
GET20G	-	100N	144g

缓冲支架 Buffer Support

尺寸 (mm) / Dimensions (mm)

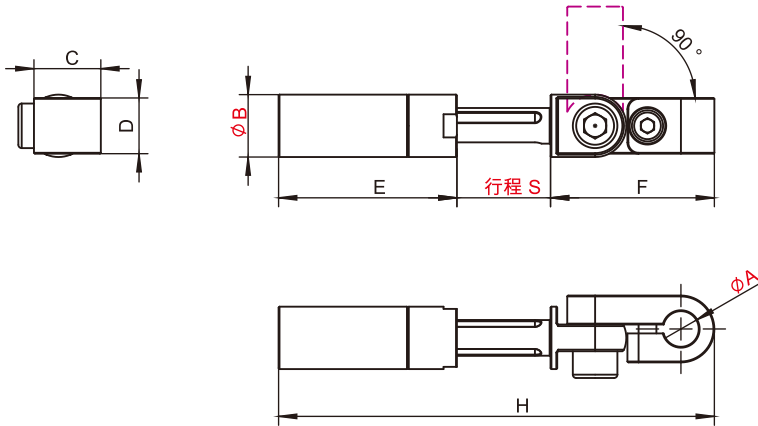

型号(Model)	A(mm)	B(mm)	C(mm)	D(mm)	E(mm)	F(mm)	H(mm)	S(mm)	重量(Weight)
VBS1421-08	8	14	15	12.5	40	36.75	97.75	21	36g
VBS2026-10	10	20	20	15	50	45.5	121.5	26	74g
VBS2026-12	12	20	20	15	50	45.5	121.5	26	73g
VBS2051-10	10	20	20	15	84	45.5	180.5	51	111g
VBS2051-12	12	20	20	15	84	45.5	180.5	51	110g

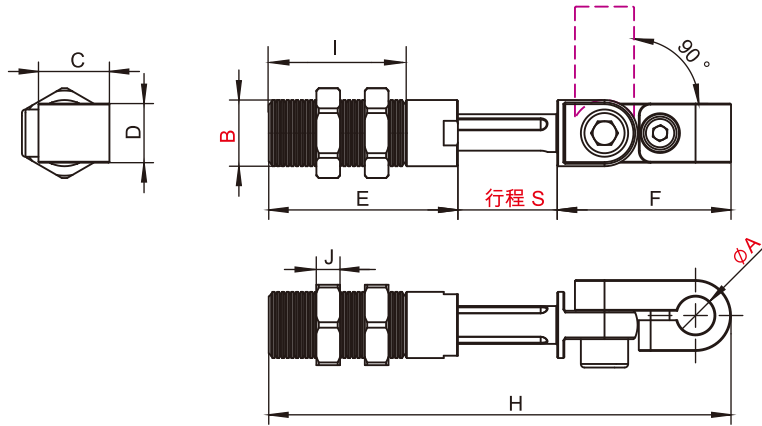

型号(Model)	A(mm)	B(mm)	C(mm)	D(mm)	E(mm)	F(mm)	H(mm)	I(mm)	J(mm)	S(mm)	重量(Weight)
VBSR 1421-08	8	M14	15	12.5	40	36.75	97.75	29	2.7	21	43g
VBSR 2026-10	10	M20	20	15	50	45.5	121.5	39	3.9	26	92g
VBSR 2026-12	12	M20	20	15	50	45.5	121.5	39	3.9	26	91g
VBSR 2051-10	10	M20	20	15	84	45.5	180.5	39	3.9	51	129g
VBSR 2051-12	12	M20	20	15	84	45.5	180.5	39	3.9	51	128g

运用实例 / Application example

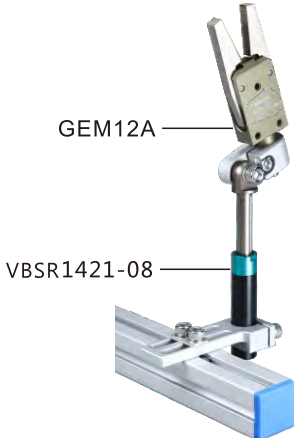

## 缓冲支架 Buffer Supporter

尺寸 (mm) / Dimensions (mm)

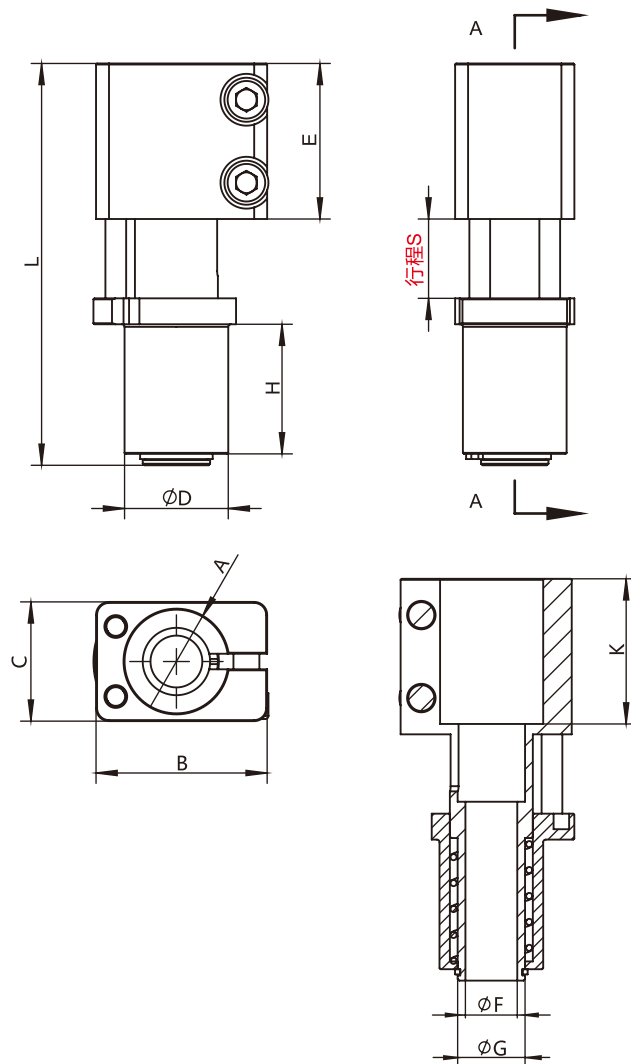

运用实例 / Application example



型号(Model)	A	B	C	D	E	F	G	H	L	K	行程S	重量(Weight)
VBSP20-14	14	31	20	20	30	10	13	25	77.5	28	15	57g
VBSP20-20	20	33	23	20	30	10	13	25	77.5	28	15	65g
VBSP30-30	30	43	33	30	30	18	22	25	77.5	28	15	108g

## 模具定位器 Mould Positioner

尺寸 (mm) / Dimensions (mm)

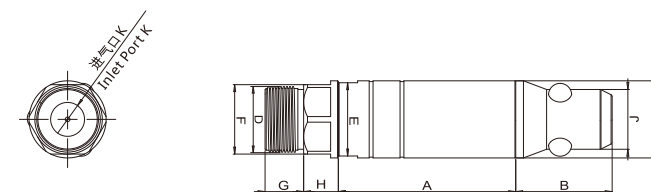

型号(Model)	A	B	D	E	F	G	H	I	J	K	最大锁持力	重量(Weight)
GMP14A	38	14	M12*1	-	12	5	4	Ø14	Ø11	M5	90N	62g
GMP20A	46	25	M17*1	19	18	10	9	Ø20	Ø15.5	G1/8	190N	78g
GMP30A	75	38	M27*1	28	27	11	10	Ø30	Ø25.5	G1/8	280N	303g

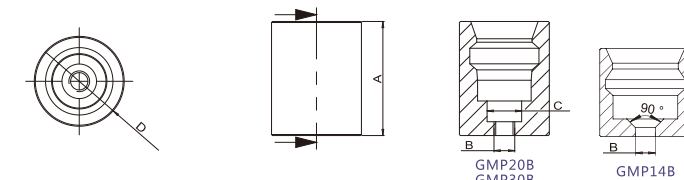

型号(Model)	A	B	C	D	精度(Precision)	重量(Weight)
GMP14B	15	M4沉头	-	15.5h7	±0.015	46g
GMP20B	33	M6(或M5沉头)	10	26h7	±0.015	87g
GMP30B	43.5	M8(或M6沉头)	11	40h7	±0.015	264g

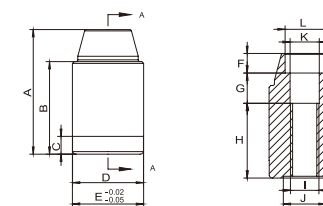

型号(Model)	A	B	C	D	E	F	G	H	I	J	K	L	重量(Weight)
GLU20A	35	26	5	Ø19.92	Ø20	5.50	8.50	21	M8	Ø12	Ø8.20	Ø11	61g

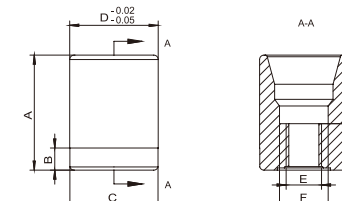

型号(Model)	A	B	C	D	E	F	G	H	重量(Weight)
GLU20B	26	5	Ø19.92	Ø20	M8	Ø11	15.50	10.50	42g

运用实例 / Application example

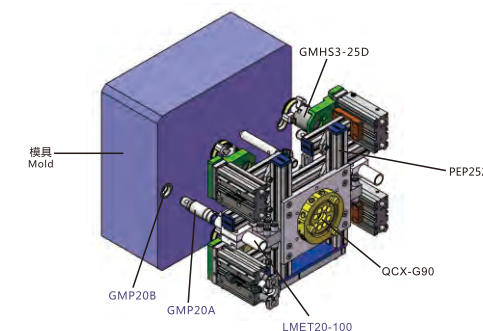

拨指选项 Finger Gripper Options

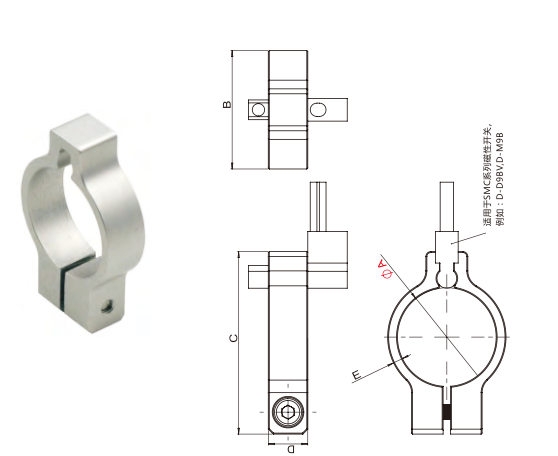

型号(Model)	GS-14	GS-20	GS-30
A(mm)	Ø14	Ø20	Ø30
B(mm)	18	24	34
C(mm)	30	37	47
D(mm)	8	8	8
E(mm)	2	2	2
重量(Weight)	14g	17g	25g

可选的磁传感器 Optional Magnetic Sensors

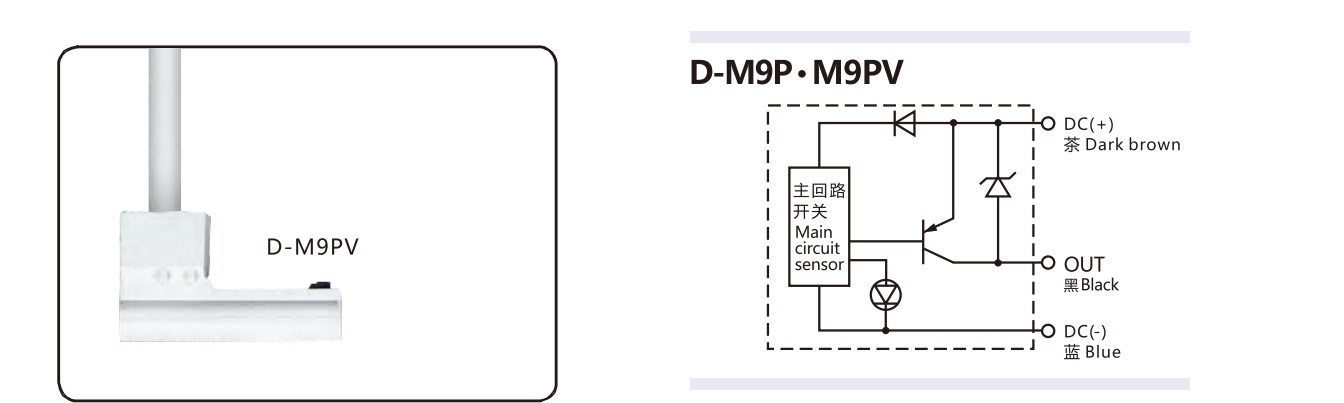

型号(Model)	开关类型	L(mm)
D-M9PV	PNP	电缆0.5m/0.5m cable
D-M9PVL		电缆3.0m/3m cable

气动针夹 (PN 系列) Pneumatic Needle Gripper(Series P N)

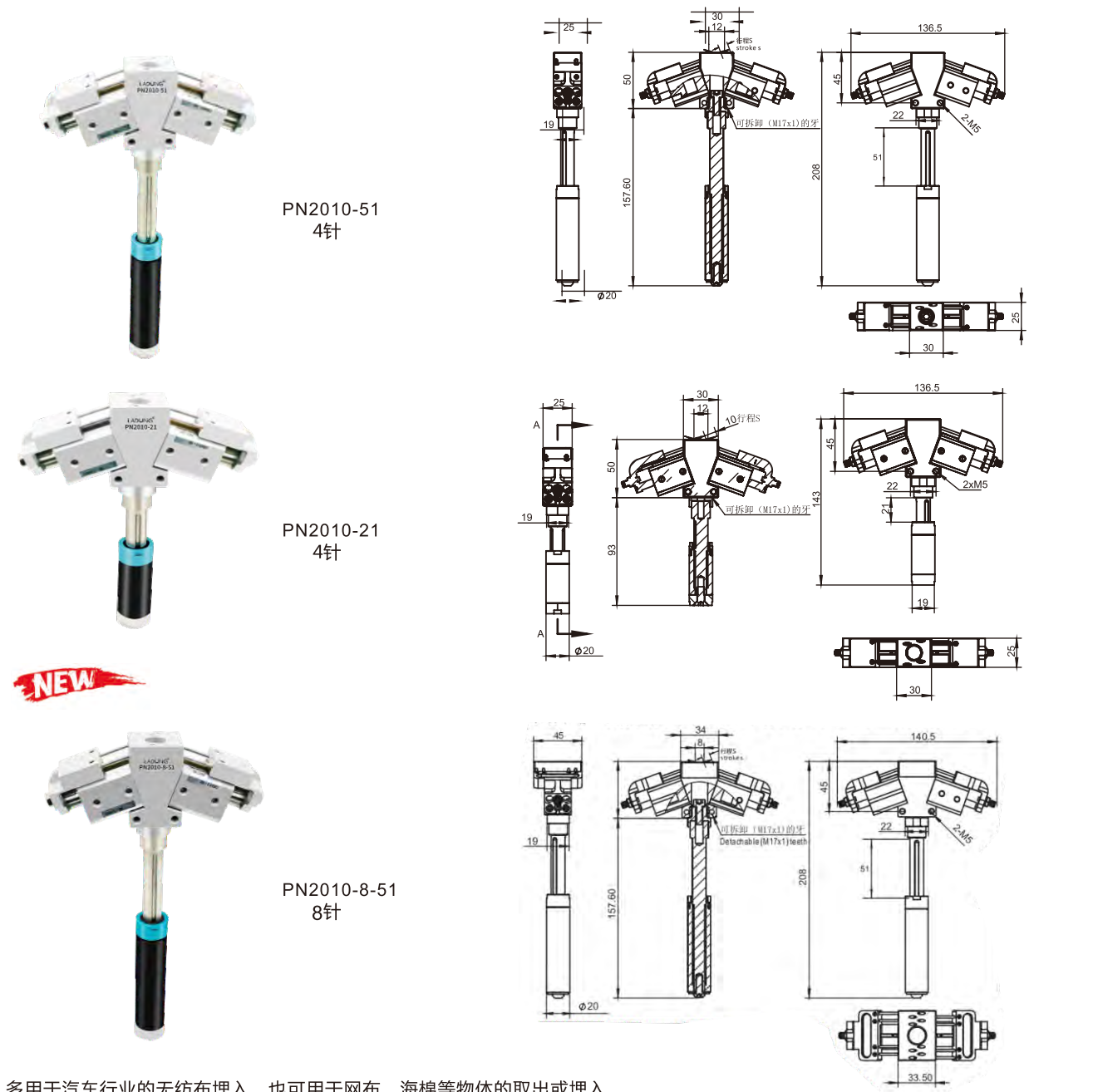

多用于汽车行业的无纺布埋入，也可用于网布、海棉等物体的取出或埋入。  
钢针的伸出长度可调节，且可以根据客户要求定制非标的钢针长度。  
*Being used for embedding and taking out nonwoven fabric, net cloth and sponge. The length of the steel needle can be not only adjustable, but also customized according to the requirements of the customer.*

型号(Model)	PN2010-51	PN2010-21	PN2010-8-51
介质 Medium	已过滤，润滑型 / 未润滑型压缩空气 Filtered, lubricated / non lubricated compressed air		
压力范围 Pressure range	3 ~ 8 bar		
温度范围 Temperature range	-10° ~ 70 °C.		
6 bar压力下打开总夹取力 Opening total gripping force at 6 bar	90 N		
针状行程S Needle stroke s	0 ~ 10 mm		
循环空气消耗量 Cycle air consumption	3.5 cm <sup>3</sup>		
重量 Weight	240g	220g	480g



气动针夹 ( PN系列) Pneumatic Needle Gripper(Series PN)

产品描述  
Product Description

多用于汽车行业的无纺布埋入，也可用于网布、海棉等物体的取出或埋入。  
钢针的伸出长度可调节，且可以根据客户要求定制非标的钢针长度。  
Being used for embedding and taking out nonwoven fabric, net cloth and sponge.The length of the steel needle can be not only adjustable,but also customized according to the requirements of the customer.



PN2010  
4针

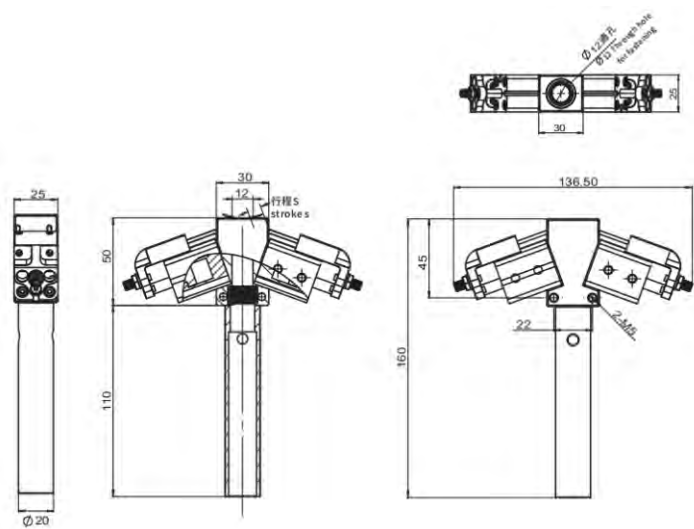

PN2010-8  
8针

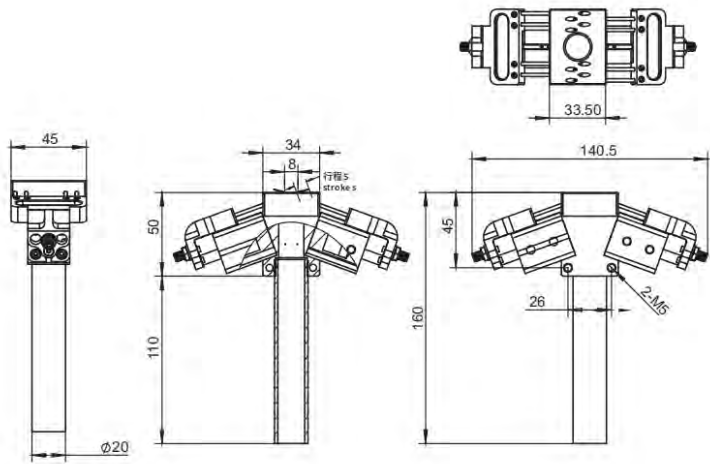

型号(Model)	PN2010	PN2010-8
重量(weight)	274g	317g

气动针夹(PN系列) Pneumatic Needle Gripper(Series PN)

产品描述  
Product Description

小针头插入深度浅，可快速释放  
搬运薄型气型工件  
可调节针的行程  
处理难以用真空吸附的材料，如复合纺织品，羊毛，  
过滤器，编织玻璃纤维或碳纤维，编织芳族聚酰胺，泡沫材料等  
Small needle insertion depth is shallow  
Can quickly release, transport thin breathable workpiece.  
Can adjust the needle stroke,  
Processing difficult to vacuum adsorption of materials, such as composite textiles, wool, filters, woven glass or carbon fiber, woven aramid, foam, etc.



PN3003-4  
4针 Pins

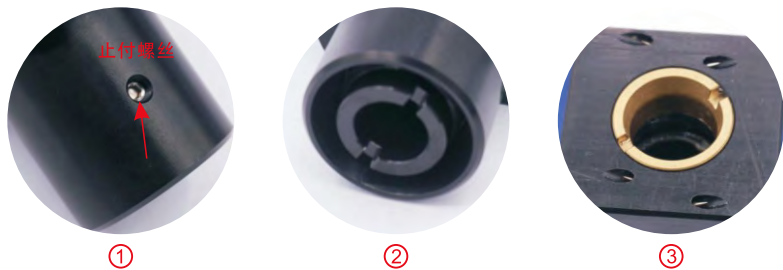

针长调节说明  
使用六角扳手拧出止付螺丝 ①  
用硬币或其他物品对准卡槽旋转调节针长 ②  
顶部铜材质更加耐磨，更换方便 ③  
Needle Length Adjustment Instructions  
Use a hex wrench to unscrew the stop screw.①  
Adjust the needle length by rotating it with a coin or other object against the slot.②  
Copper top is more wear-resistant and easy to replace.③

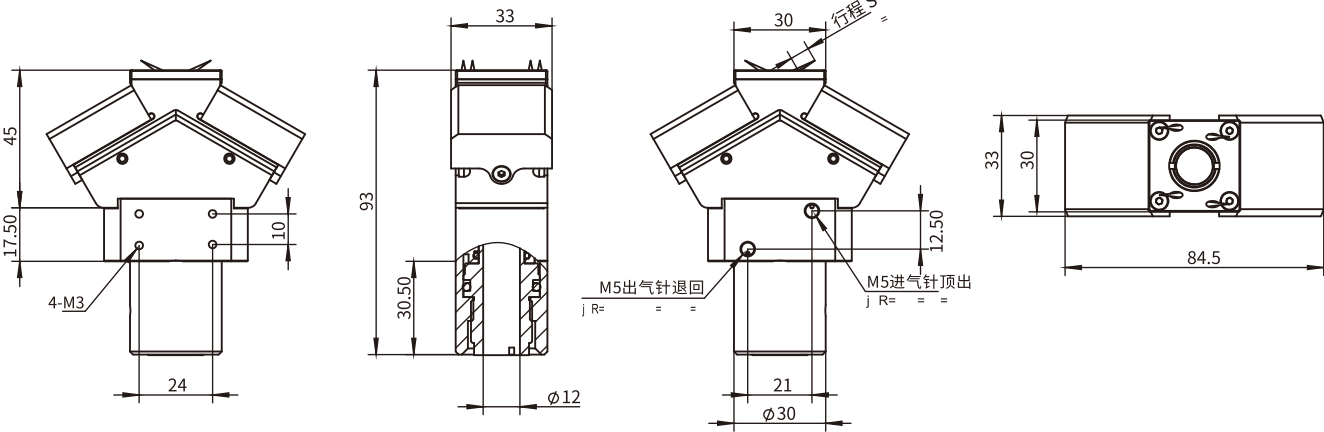

型号(Model)	PN3003-4
重量Weight	188g

## 鼓胀器 Bulging Device

### 型号表示方法

#### Model representation methods



基本尺寸  
**basic size**  
缸体直径  
Body Diameter

GBD 18

中间通孔  
**Middle through hole**

动作方向  
**Actuation direction**  
D - 向下  
D - Downward  
U - 向上  
U - Upward

向下或向上。  
橡皮圈部分可由硅橡胶制成。  
夹取尺寸可从18 到 31 mm不等。  
多种安装附件。

Downward movement, or Upward movement.  
The elastic part can be in Silicone or Rubber.  
Grip diameters from 18 to 31 mm.  
Several mounting accessories.

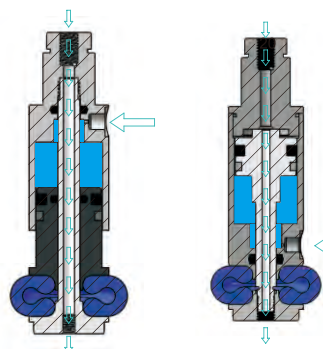

GBD...HD

GBD...HU

过孔

H型号拥有一个中央过孔。可吹送压缩空气，或通过冷却部件或检查泄露的方式提供真空。

Through hole for fastening

The ...H models have a central through hole. It can be used to blow compressed air, or to provide vacuum, with the purpose to cool a part, or to check the leakage.

橡胶圈部分采用蓝色硅橡胶或透明硅橡胶。  
硅橡胶可提供较高的温度范围，确保较长的使用寿命。  
硅橡胶(蓝色或透明)橡胶圈可作为备件，磨损后可替换。  
硅橡胶制成的橡胶圈预计可使用100万次。

The elastic part can be in blue Silicone, or transparent silicone.  
Silicone can be used over a wider temperature range and assures a longer life time.  
The elastic part in Silicone is available as a spare part and can be replaced, when worn out.  
The expected medium life time of the elastic part in Silicone is about 1 million cycles.

备用的橡胶圈部件  
Spare elastic part



S1  
蓝色硅橡胶  
Blue Silicone



S2  
透明硅橡胶  
Transparent silicone

橡胶圈出货时可有客户选定  
Silicone can be shipped by customers

规格(Spec.)	Ø18	Ø22
型号 (Mode)	18-S1	22-S1
型号 (Mode)	18-S2	22-S2
鼓胀器(Bulging device)	GBD18U	GBD22HU
	GBD18HD	

T-橡胶圈部件的操作温度(夹具主体5~60°C)

T - Operating temperature of the elastic part (5~60°C for the gripper body)

## 鼓胀器 Bulging Device



型号(Model)	重量(Weight)
GBD14HD	24g



型号(Model)	重量(Weight)
GBD22HD	41g



型号(Model)	重量(Weight)
GBD18HD	33g



型号(Model)	重量(Weight)
GBD30HD	60g

### 运用实例 / Application example

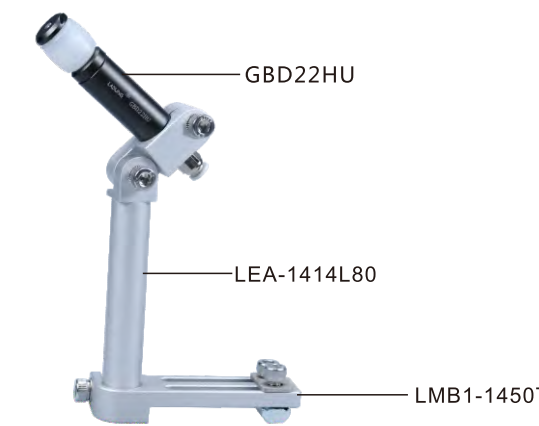
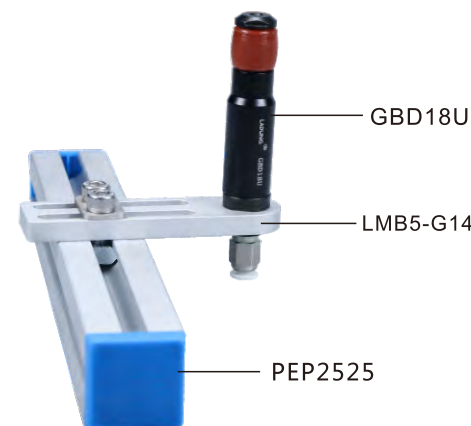

单动拨指 (0F系列) One Finger Angular Pneumatic Grippers (Series OF)

- 单一动作。
- 内置磁环。
- Single acting.
- Built-in magnetic ring

OFA...-35

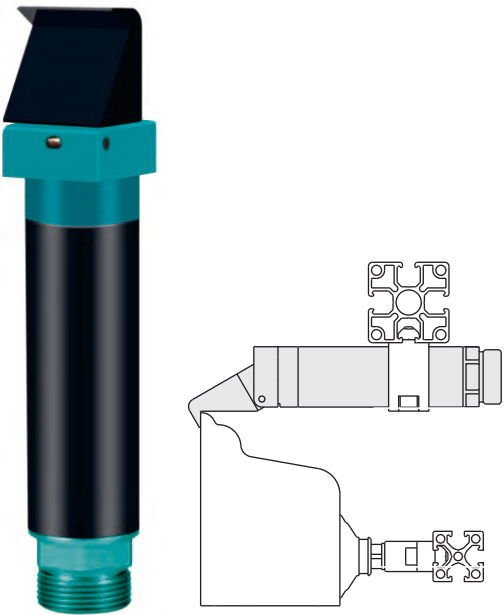

型号(Model)	OFA14-35	OFA20-35	OFA30-35
介质 Medium	已过滤, 润滑型 / 未润滑型压缩空气 Filtered, lubricated / non lubricated compressed air		
夹具体 Gripper body	铝制的 Aluminium		
压力范围 Pressure range	2.5 ~ 8 bar		
温度范围 Temperature range	-10 ~ 70 °C.		
行程 Stroke	35°		
活塞孔 Piston bore	Ø10 mm	Ø16 mm	Ø25 mm
6 bar压力下的关闭扭矩 Closing torque at 6 bar	26 Ncm	100 Ncm	430 Ncm
循环空气消耗量 Cycle air consumption	0.4 cm³	1.24 cm³	4.56 cm³
重量 Weight	25g	65g	206g
内置磁环 Built-in magnetic ring	有 Yes	有 Yes	有 Yes

型号(Model)	OFA14-35	OFA20-35	OFA30-35
A	14	20	30
B	14	20.5	30
C	10.5	9	12
D	49.5	76.5	111
E	5.5	8	11
F	13.5	20.2	30.5
G	4.5	6	8
H	74	106	153
I	Ø14	Ø20	Ø30
J	12	17	27
K	M5	M5	
M	M12×1	M17×1	M27×1

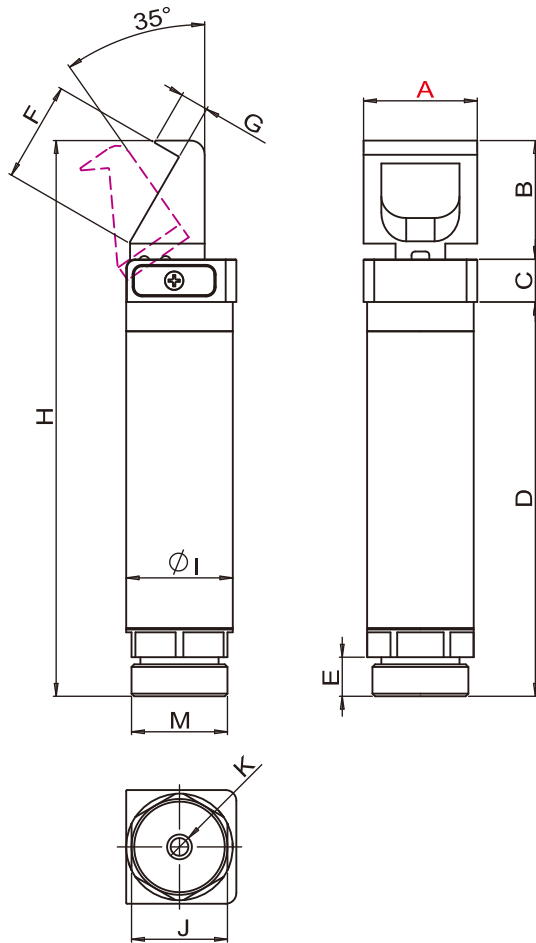

单动拨指 (0F系列) One Finger Angular Pneumatic Grippers(Series OF)

- 单一动作。
- 内置磁环。
- Single acting.
- Built-in magnetic ring

OFR...-95

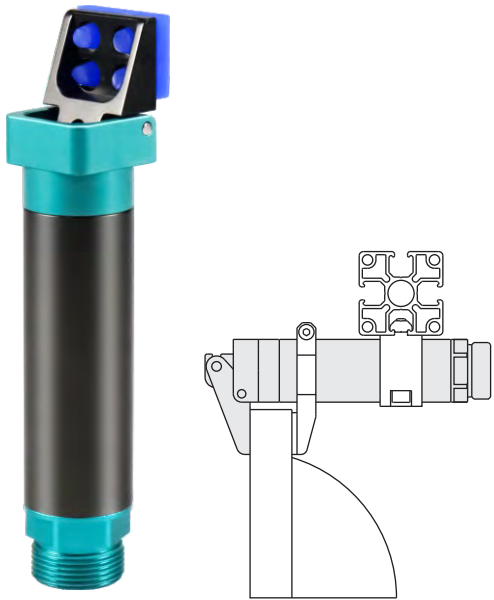

型号(Model)	OFR14-95	OFR20-95	OFR30-95
介质 Medium	已过滤, 润滑型 / 未润滑型压缩空气 Filtered, lubricated / non lubricated compressed air		
夹具体 Gripper body	铝制的 Aluminium		
压力范围 Pressure range	2.5 ~ 8 bar		
温度范围 Temperature range	-10 ~ 70 °C.		
行程 Stroke	95°		
活塞孔 Piston bore	Ø10 mm	Ø16 mm	Ø25 mm
6 bar压力下的关闭扭矩 Closing torque at 6 bar	19 Ncm	70 Ncm	300 Ncm
循环空气消耗量 Cycle air consumption	1cm³	3.52 cm³	12.9 cm³
重量 Weight	25g	60g	193g
内置磁环 Built-in magnetic ring	有 Yes	有 Yes	有 Yes
备注 Remark			

型号(Model)	OFR14-95	OFR20-95	OFR30-95
A	14	20	30
B	12	17.5	25
C	10.5	9	12
D	49.5	76.5	111
E	5.5	8	11
F	14	20	29
G	2	2.5	4
H	73	104	148
I	Ø14	Ø20	Ø30
J	12	17	27
K	M5	M5	G1/8
M	M12×1	M17×1	M27×1

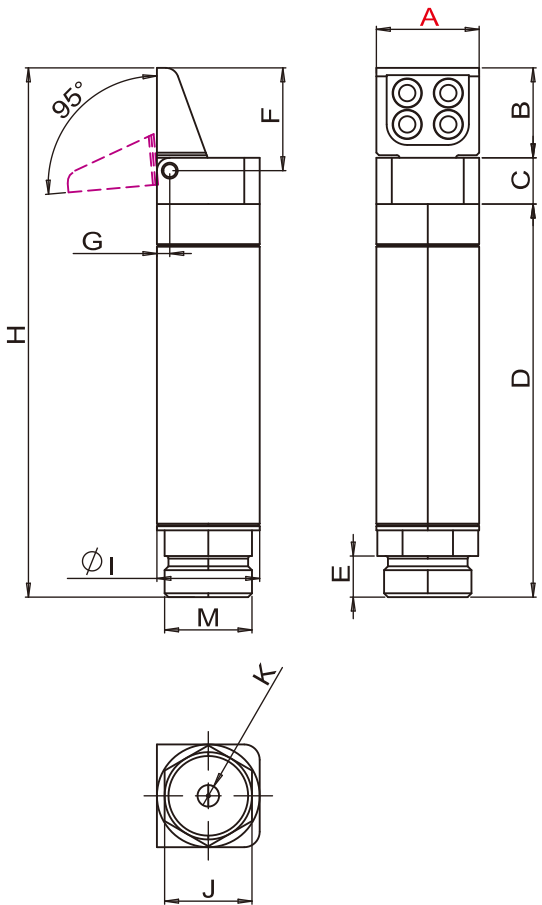



单动拨指 (OF系列) One Finger Angular Pneumatic Grippers (Series OF)

- 单一动作。
- 内置磁环。
- Single acting.
- Built-in magnetic ring

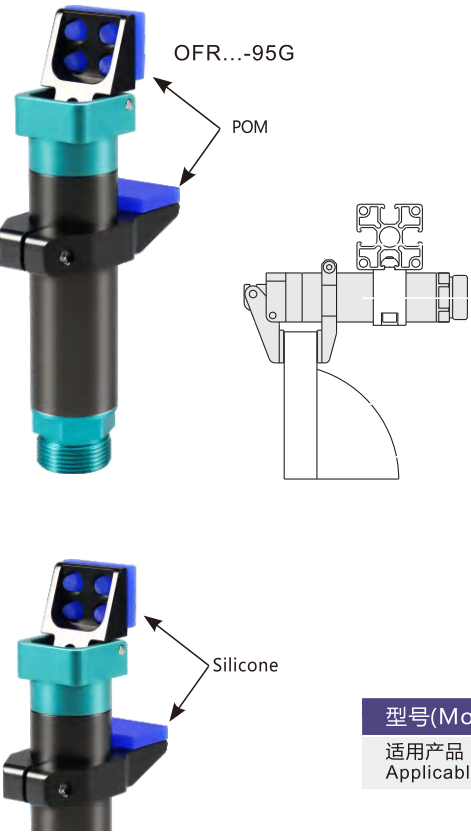

型号(Model)	OFR14-95G	OFR20-95G	OFR30-95G
介质 Medium	已过滤, 润滑型 / 未润滑型压缩空气 Filtered, lubricated / non lubricated compressed air		
夹具体 Gripper body	铝制的 Aluminium		
压力范围 Pressure range	2.5 ~ 8 bar		
温度范围 Temperature range	-10 ~ 70 °C.		
行程 Stroke	95°		
活塞孔 Piston bore	Ø10 mm	Ø16 mm	Ø25 mm
6 bar压力下的关闭扭矩 Closing torque at 6 bar	19 Ncm	70 Ncm	300 Ncm
循环空气消耗量 Cycle air consumption	1cm <sup>3</sup>	3.52cm <sup>3</sup>	12.9 cm <sup>3</sup>
重量 Weight	36g	87g	300g
内置磁环 Built-in magnetic ring	有 Yes	有 Yes	有 Yes
备注 Remark			

型号(Model)	SIL-14G (硅胶垫片)	SIL-20G(硅胶垫片)	SIL-30G(硅胶垫片)
适用产品 Applicable Products	OFR14-95G	OFR20-95G OFR20-95LG OFR20-95SG	OFR30-95G

型号(Model)	OFR14-95G	OFR20-95G	OFR30-95G
A	14	20	30
B	12	17.5	25
C	10.5	9	12
D	49.5	76.5	111
E	5.5	8	11
F	14	20	29
G	2	2.5	4
H	73	104	148
I	Ø14	Ø20	Ø30
J	12	17	27
K	M5	M5	G1/8
L	2.5	2.5	3
M	M12×1	M17×1	M27×1
N	11	15	20
O	32	46	63
P	19	25	37
Q	14	20	30
R	19	27.5	40

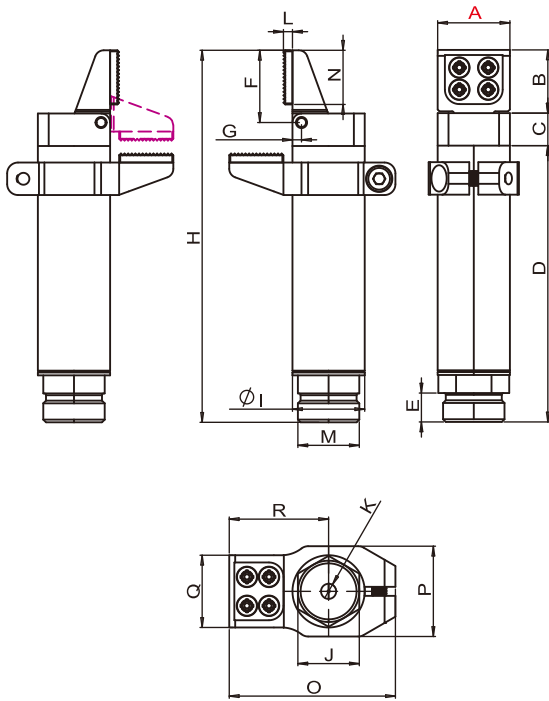

单动拨指 (OF系列) One Finger Angular Pneumatic Grippers (Series OF)

- 单一动作。
- 内置磁环。
- Single acting.
- Built-in magnetic ring

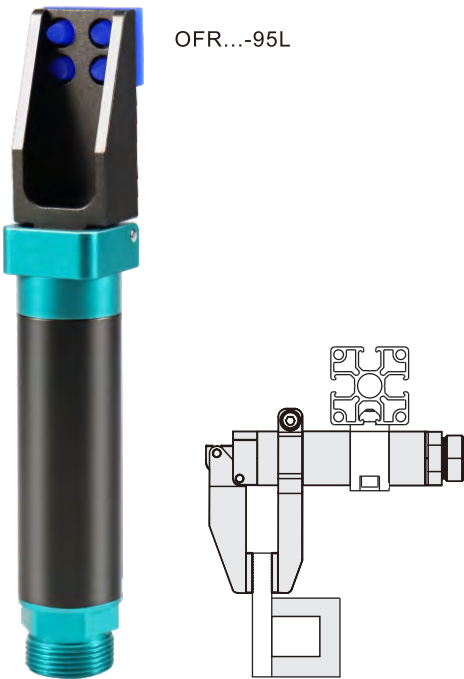

型号(Model)	OFR14-95L	OFR20-95L	OFR30-95L
介质 Medium	已过滤, 润滑型 / 未润滑型压缩空气 Filtered, lubricated / non lubricated compressed air		
夹具体 Gripper body	铝制的 Aluminium		
压力范围 Pressure range	2.5 ~ 8 bar		
温度范围 Temperature range	-10 ~ 70 °C.		
行程 Stroke	95°		
活塞孔 Piston bore	Ø10 mm	Ø16 mm	Ø25 mm
6 bar压力下的关闭扭矩 Closing torque at 6 bar	19 Ncm	70 Ncm	300 Ncm
循环空气消耗量 Cycle air consumption	1cm <sup>3</sup>	3.52 cm <sup>3</sup>	12.9 cm <sup>3</sup>
重量 Weight	32g	81.4g	218g
内置磁环 Built-in magnetic ring	有 Yes	有 Yes	有 Yes
备注 Remark			

型号(Model)	OFR14-95L	OFR20-95L	OFR30-95L
A	14	20	30
B	23	39	48
C	10.5	9	12
D	49.5	76.5	111
E	5.5	8	11
F	24	40	49.5
G	2	2.5	4
H	93	127	170
I	Ø14	Ø20	Ø30
J	12	17	27
K	M5	M5	G1/8
M	M12×1	M17×1	M27×1

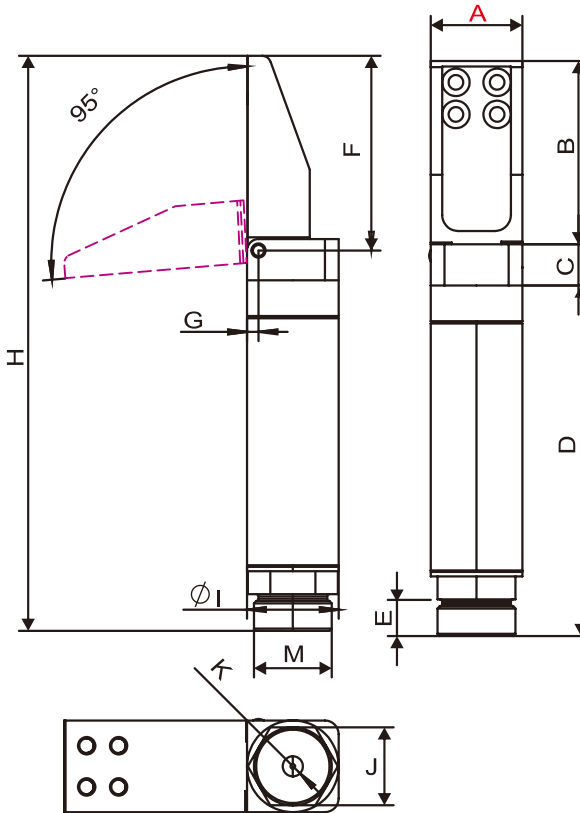

单动拨指 (OF系列) One Finger Angular Pneumatic Grippers (Series OF)

- 单一动作。
- 内置磁环。
- Single acting.
- Built-in magnetic ring

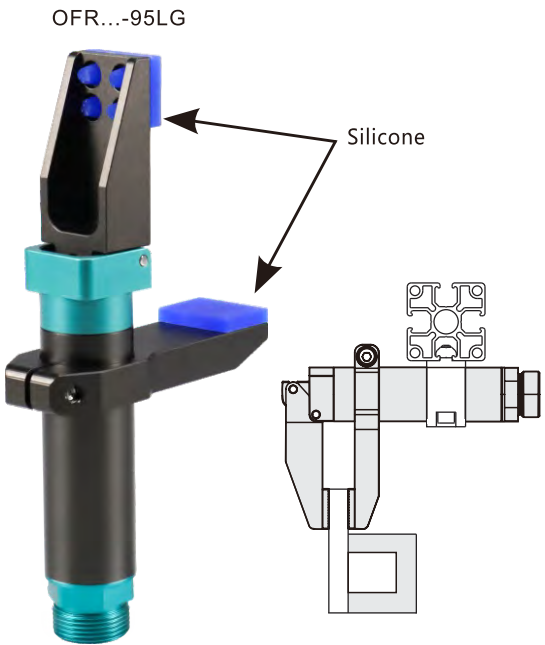

型号(Model)	OFR14-95LG OFR20-95LG OFR30-95LG		
介质 Medium	已过滤, 润滑型 / 未润滑型压缩空气 Filtered, lubricated / non lubricated compressed air		
夹具体 Gripper body	铝制的 Aluminium		
压力范围 Pressure range	2.5 ~ 8 bar		
温度范围 Temperature range	-10 ~ 70 °C.		
行程 Stroke	95°		
活塞孔 Piston bore	Ø10 mm	Ø16 mm	Ø25 mm
6 bar压力下的关闭扭矩 Closing torque at 6 bar	19 Ncm	70 Ncm	300 Ncm
循环空气消耗量 Cycle air consumption	1cm³	3.52 cm³	12.9 cm³
重量 Weight	45g	104.8g	272g
内置磁环 Built-in magnetic ring	有 Yes	有 Yes	有 Yes
备注 Remark			

型号(Model)	SIL-14G(硅胶垫片)	SIL-20G(硅胶垫片)	SIL-30G(硅胶垫片)
适用产品 Applicable Products	OFR14-95LG OFR14-95G OFR14-95L	OFR20-95G OFR20-95LG OFR20-95SG	OFR30-95LG OFR30-95G OFR30-95L

型号(Model)	OFR14-95LG	OFR20-95LG	OFR30-95LG
A	14	20	30
B	23	39	48
C	10.5	9	12
D	49.5	76.5	111
E	5.5	8	11
F	24	40	49.5
G	2	2.5	4
H	93	127	170
I	Ø14	Ø20	Ø30
J	12	17	27
K	M5	M5	G1/8
L	2.5	2.5	3
M	M12×1	M17×1	M27×1
N	11	15	20
O	46	68.5	88
P	19	25	37
Q	14	20	30
R	30	50	62

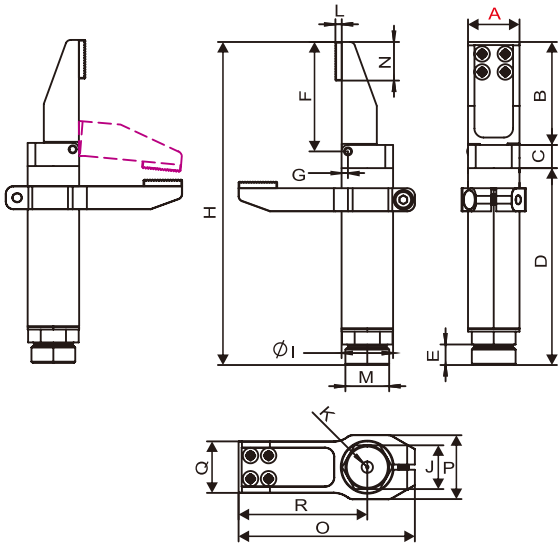

单动拨指 (OF系列) One Finger Angular Pneumatic Grippers (Series OF)

- 单一动作。
- 内置磁环。
- Single acting.
- Built-in magnetic ring

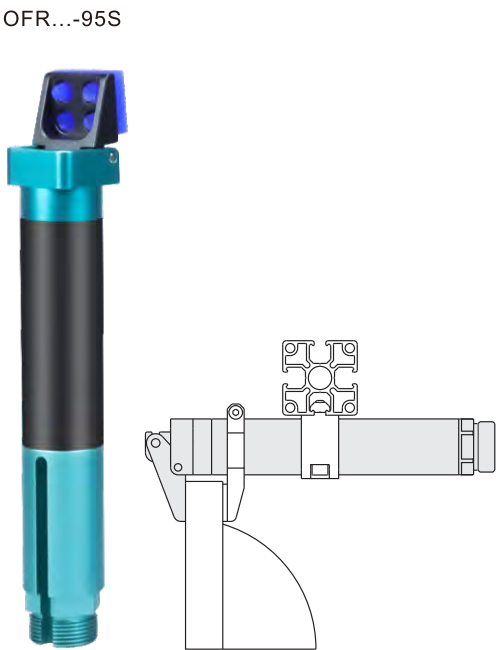

型号(Model)	OFR20-95S	OFR30-95S
介质 Medium	已过滤, 润滑型 / 未润滑型压缩空气 Filtered, lubricated / non lubricated compressed air	
夹具体 Gripper body	铝制的 Aluminium	
压力范围 Pressure range	2.5 ~ 8 bar	
温度范围 Temperature range	-10 ~ 70 °C.	
行程 Stroke	95°	
活塞孔 Piston bore	Ø16 mm	Ø25 mm
6 bar压力下的关闭扭矩 Closing torque at 6 bar	70 Ncm	300 Ncm
循环空气消耗量 Cycle air consumption	3.52 cm³	12.9 cm³
重量 Weight	60g	193g
内置磁环 Built-in magnetic ring	有 Yes	有 Yes
备注 Remark		

型号(Model)	OFR20-95S	OFR30-95S
A	20	30
B	17.5	25
C	9	12
D	111.5	165
E	8	11
F	20	30
G	2.5	4
H	139	215
I	Ø20	Ø30
J	17	27
K	M5	G1/8
M	M17×1	M27×1
L	41	45

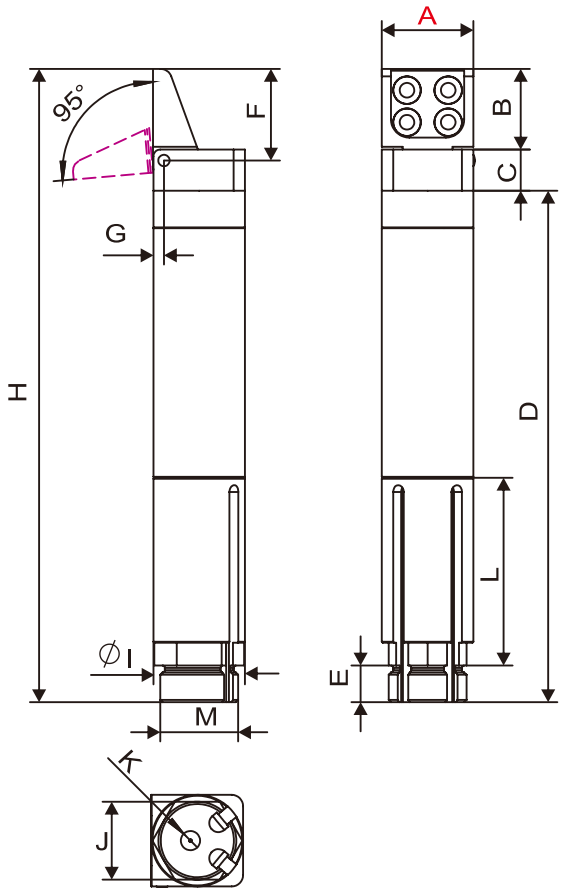

## 单动拨指 (OF系列) One Finger Angular Pneumatic Grippers (Series OF)

- 单一动作。
- Single acting.
- 内置磁环。
- Built-in magnetic ring



OFR...-95SG

型号(Model)	OFR20-95SG	OFR30-95SG
介质 Medium	已过滤, 润滑型 / 未润滑型压缩空气 Filtered, lubricated / non lubricated compressed air	
夹具体 Gripper body	铝制的 Aluminium	
压力范围 Pressure range	2.5 ~ 8 bar	
温度范围 Temperature range	-10 ~ 70 °C.	
行程 Stroke	95°	
活塞孔 Piston bore	Ø16 mm	Ø25 mm
6 bar压力下的关闭扭矩 Closing torque at 6 bar	70 Ncm	300 Ncm
循环空气消耗量 Cycle air consumption	3.52 cm <sup>3</sup>	12.9 cm <sup>3</sup>
重量 Weight	60g	193g
内置磁环 Built-in magnetic ring	有 Yes	有 Yes
备注 Remark		

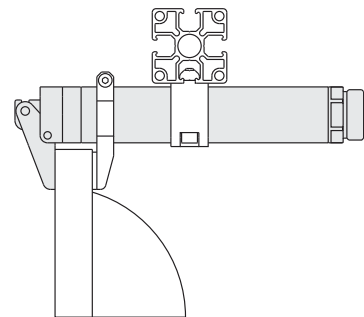

型号(Model)	SIL-20G(硅胶垫片)	SIL-30G(硅胶垫片)
适用产品 Applicable Products	OFR20-95G OFR20-95LG OFR20-95SG	OFR30-95LG OFR30-95G OFR30-95L

型号(Model)	OFR20-95SG	OFR30-95SG
A	20	30
B	17.5	25
C	9	14
D	111.5	165
E	8	11
F	20	30
G	2.5	4
H	139	215
I	Ø20	Ø30
J	17	27
K	M5	G1/8
L	41	45
M	M17×1	M27×1
N	15	20
O	46	63
P	25	37
Q	20	30
R	27.5	40
T	2.5	3

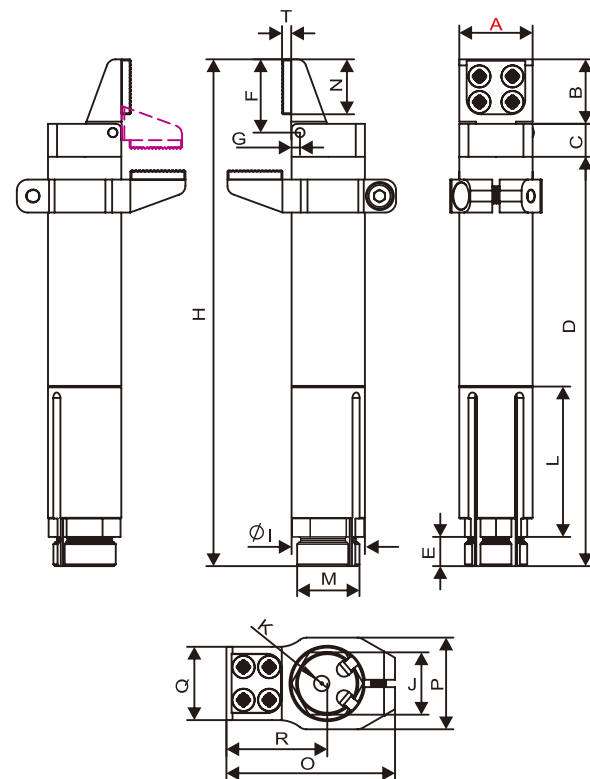

## 拨指选件 Finger Gripper Options

型号(Model)	GP1-20	GP1-30
A(mm)	Ø20	Ø30
B(mm)	30	45
C(mm)	37	65
D(mm)	21	32
E(mm)	33	44
F(mm)	15	20
重量(Weight)	20g	60g

型号(Model)	GP2-14	GP2-20	GP2-30
A(mm)	Ø14	Ø20	Ø30
B(mm)	24	35	45
C(mm)	19	25	35
D(mm)	12	25	25
E(mm)	11	16	21
F(mm)	6	13	13
G	3.5	5	5.5
重量(Weight)	5g	14g	23g

型号(Model)	GP3-14	GP3-20	GP3-20L	GP3-30
A(mm)	Ø14	Ø20	Ø20	Ø30
B(mm)	19	25	25	37
C(mm)	14	20	50	30
D(mm)	32	43.5	68.5	63
E(mm)	19	27.5	20	40
F(mm)	10	9.5	15	12
H(mm)	11	15	11.5	20
G(mm)	6	7	9	9
重量(Weight)	6g	12g	19.8g	30g
	Silicone	Silicone	Silicone	POM

型号(Model)	GS-14	GS-20	GS-30
A(mm)	Ø14	Ø20	Ø30
B(mm)	18	24	34
C(mm)	30	37	47
D(mm)	8	8	8
E(mm)	2	2	2
重量(Weight)	14g	17g	25g

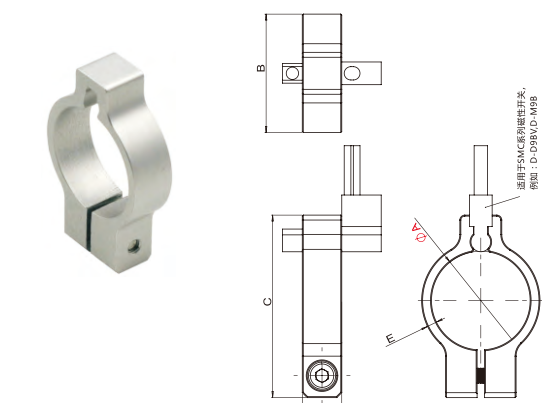
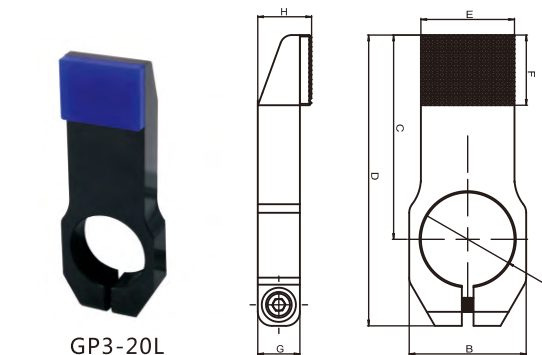
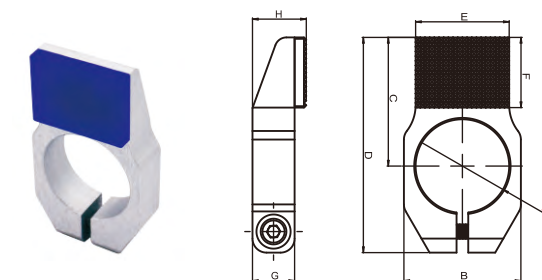
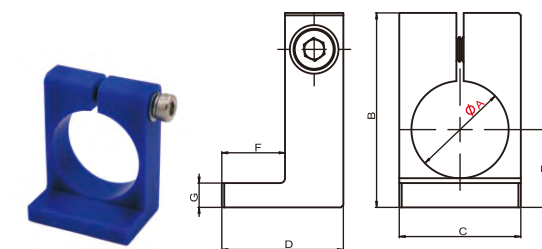
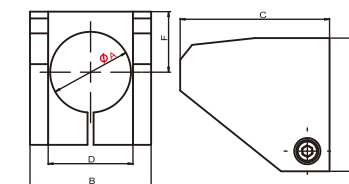



## 单动拨指 (0F系列) One Finger Angular Pneumatic Grippers (Series OF)

NEW



OFP-20-VMQ

OFP-20-NBR

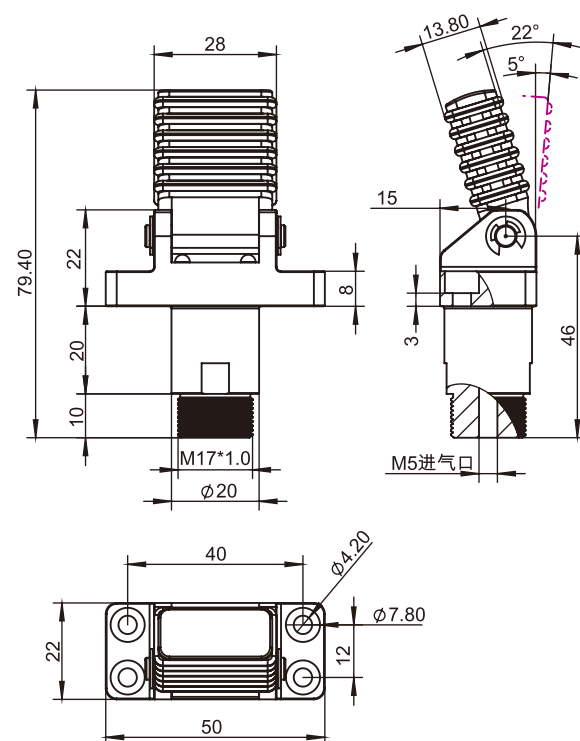

型号 (Model)	重量 (Weight)	耐高温 Heat resistance (in °C)
OFP20-20-NBR	57.4g	-20 to 80
OFP20-20-VMQ	57.4g	-40 to 160

NEW



OFG-20-VMQ

OFG-20-NBR

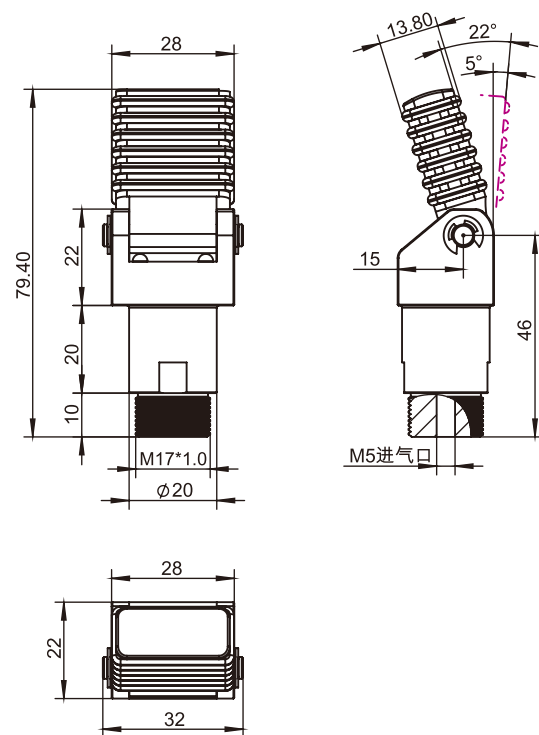

型号 (Model)	重量 (Weight)	耐高温 Heat resistance (in °C)
OFG20-20-NBR	50g	-20 to 80
OFG20-20-VMQ	50g	-40 to 160

## 可选的磁传感器 Optional Magnetic Sensors

磁性传感器 (可选) 通过活塞上的一个磁铁检测出操作位置。因此, 使用磁传感器是为了避免大量的磁性材料和强烈的磁场可能会造成传感问题。

可用的传感器:

The operating position is detected by magnetic proximity sensors (optional) through a magnet placed on the piston. The use of magnetic proximity sensors is to be avoided in the vicinity of large masses of ferromagnetic material or intense magnetic fields as this may cause detection problems. The sensors that can be used are:

### D-M9N • M9NV

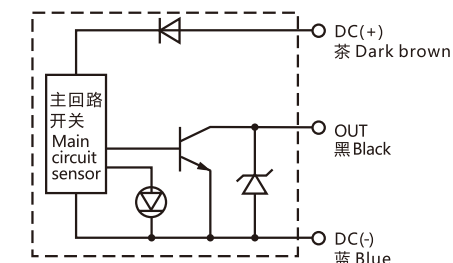

### D-M9P • M9PV

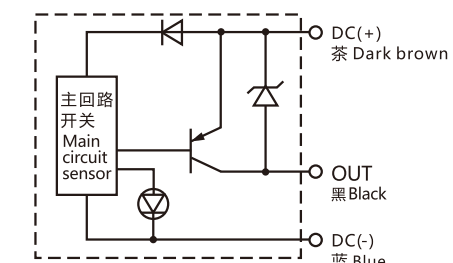

### D-M9B • M9BV

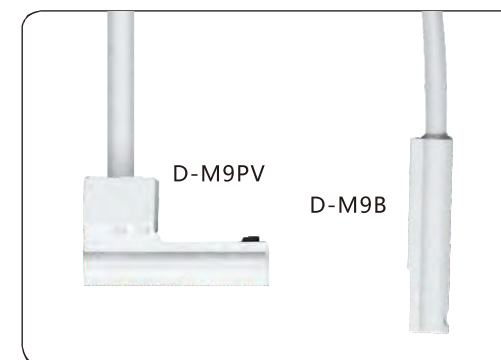
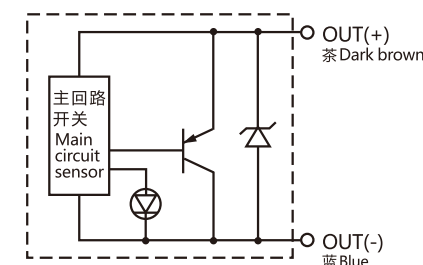

型号 (Model) D-MQ

型号 (Model)	开关类型	L (mm)
D-M9B	NPN	电缆 0.5m/0.5m cable
D-M9BL		电缆 3.0m/3m cable
D-M9BV	NPN	电缆 0.5m/0.5m cable
D-M9BVL		电缆 3.0m/3m cable
D-M9N	NPN	电缆 0.5m/0.5m cable
D-M9NL		电缆 3.0m/3m cable
D-M9NV	NPN	电缆 0.5m/0.5m cable
D-M9NVL		电缆 3.0m/3m cable
D-M9P	PNP	电缆 0.5m/0.5m cable
D-M9PL		电缆 3.0m/3m cable
D-M9PV	PNP	电缆 0.5m/0.5m cable
D-M9PVL		电缆 3.0m/3m cable